



OVERHEAD PRIMARY TAPS HOT LINE TAP CLAMPS ALUMINUM

ALUMINUM
AH/S1500

- For Aluminum and ACSR conductor.
- Designed for standard "hot stick" application.

Material: **Body and Keeper** - Aluminum Alloy
Eyebolt - Bronze Alloy - Tin Plated
Eyestem - Bronze Alloy, Forged or Stainless Steel
Spring (on eyestem) - Stainless Steel

For Factory greased and bagged clamps, see notes below table.

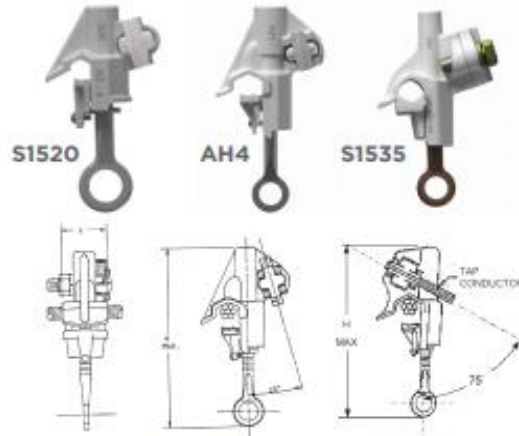

FIGURE 1

FIGURE 2

Product Data & Conductor Size

CATALOG NUMBER	MAIN LINE	TAP	FIG. NO.	PLATING	CONDUCTOR RANGE (AWG OR KCMIL)				DIMENSIONS INCHES (MM)		TAP NUT (ACROSS FLATS)	AP-PROX. WT. EACH LBS. (KG.)		
					MAIN		TAP		L	H				
					AAC	ACSR	AAC/CU	ACSR						
*S1520AA	AL	AL	1	None	#8 - 2/0 Str.	n/a	#8 - 1/0	n/a	#8 Sol. - 2/0 Str.	#8 - 1/0	1.0 (25.4)	5.25 (133)	9/16 (14.3)	0.4 (0.18)
*S1520AGP	AL	AL/CU		Tin plated	---0.128 - 0.414--- (3.25 - 10.54)									
AH4** (#)	AL	AL	1	None	#6 Sol. - 600	#6 Str. - 3/0 Str.	#8 - 558.5 (18/1)	#6 - 3/0	#6 Sol. - 266.8	#8 - 4/0	1.75 (44)	7.75 (196)	9/16 (14.3)	0.8 (0.36)
AH4GP** (#)	AL	AL/CU		Tin plated	---0.157 - 0.905--- (4.00 - 23.03)				---0.157 - 0.593--- (4.00 - 15.07)					
*S1530AA (#)	AL	AL	2	None	#6 Sol. - 400	#6 Str. - 2/0 Str.	#6 - 397.5 (18/1)	#4 - 1/0	#6 Sol. - 4/0 Str.	#6 - 3/0	1.75 (44)	7.13 (181)	11/16 (17.5)	0.64 (0.29)
*S1530AC (#)	AL	CU		AC Trans+										
*S1530AGP	AL	AL/CU		Tin plated										
*S1534AGP	AL	AL/CU		Tin plated	---0.162 - 0.745--- (4.12 - 18.96)				---0.162 - 0.547--- (4.12 - 13.92)			3/4 (19)		
*S1535AA	AL	AL	3	None	#3 Str. - 477	#4 - 3/0 Str.	#4 - 397.5	#4 - 2/0	#4 Str. - 477	#8 - 397.5	1.50 (38)	7.75 (196)	3/4 (19)	0.88 (0.40)
*S1535AGP	AL	AL/CU		Tin plated	---0.250 - 0.806--- (6.36 - 20.51)				---0.204 - 0.806--- (5.19 - 20.51)					
*S1540AC (#)	AL	CU	2	AC Trans+	4/0 Str. - 800	#4 Str. - 4/0	3/0 (6/1) - 636 (30/19)	#4 - 266.8	#4 Sol. - 350	#6 - 266.8	1.81 (46)	7.31 (186)	3/4 (19)	0.98 (0.45)
*S1540AGP	AL	AL/CU		Tin plated	---0.502 - 1.031--- (12.78 - 26.24)				---0.198 - 0.703--- (5.03 - 17.89)					
AH7** (#)	AL	AL	2	None	4/0 Str. - 800	#4 Str. - 4/0	3/0 (6/1) - 636 (30/19)	#4 - 266.8	#4 Sol. - 350	#6 - 266.8	1.81 (46)	7.31 (186)	3/4 (19)	0.98 (0.45)
AH7GP** (#)	AL	AL/CU		Tin plated	---0.502 - 1.031--- (12.78 - 26.24)				---0.198 - 0.703--- (5.03 - 17.89)					
*S1545AA	AL	AL	2	None	700 Str. - 1500	266.8 - 715.5	556.5 (30/7) - 1510 45/7	266.8 - 556.5	#4 Sol. - 300	#6 - 266.8	2.19 (56)	9.63 (245)	3/4 (19)	1.35 (0.61)
*S1545AGP	AL	AL/CU		Tin plated	---0.939 - 1.490--- (23.90 - 37.92)				---0.198 - 0.703--- (5.03 - 17.89)					

* Replace Prefix "S" with "P" for factory greased and bagged part (i.e. P1534AGP).

** Add "XB" Suffix for factory greased and bagged part (i.e. AH7GPXB).

#RUS Listed

* Aluminum/Copper bimetallic washer in eyebolt.