

A | B | C | D | E | F

PAPER SIZE		DRAWING NUMBER	
B SIZE		GD-J6650	
REV	REVISION DATE	ECO	
A	07-28-09	9596	

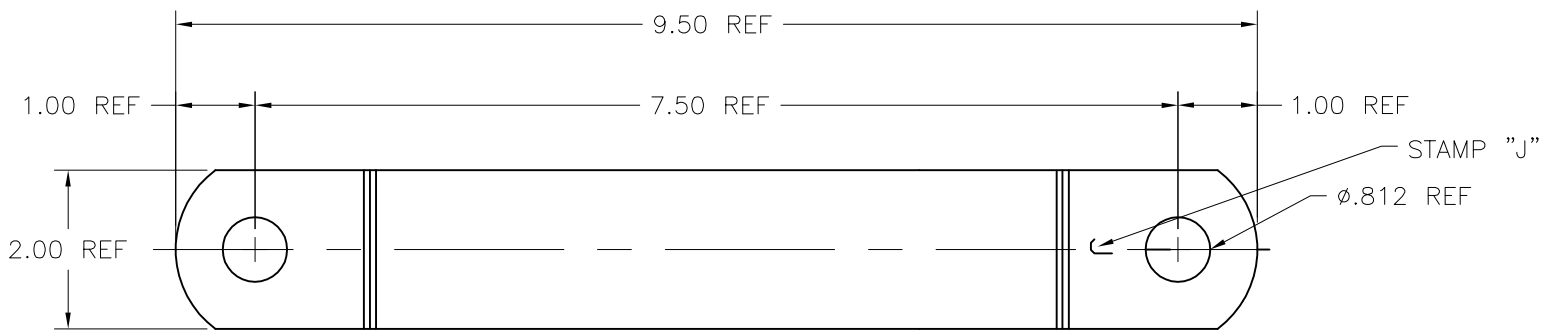
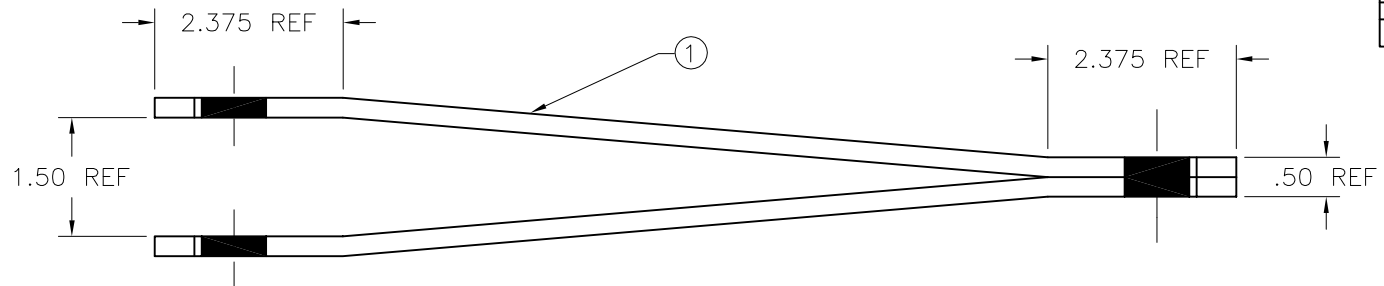

ITEM	QTY	DESCRIPTION
1	2	CONNECTING LINK

**NOTES:**  
 1) ALL DIMENSIONS ARE REFERENCE AND ARE IN INCHES.  
 2) HOT DIP GALVANIZED ASTM A-153. INSPECT PER CLASS 2C.

CATALOG NUMBER J6650

This drawing contains confidential information that is the property of MacLean Power, L.L.C. ("MacLean"). Use of MacLean's confidential information without MacLean's express written consent is strictly prohibited and may expose you to legal liability. If you believe that you received this material in error, please destroy it or return it to "MacLean Power, L.L.C., 11411 Addison, Franklin Park, Illinois 60131, USA."

F102414  
 DRAWING-COMPUTER LOCATION:

TOLERANCES UNLESS SPECIFIED	
inch	
0.XX	— — —
0.XXX	— — —
ANGLE	— — —



DRAWN BY	ENGINEER	CHECKER	CATALOG #	SCALE	DESIGN DATE
RC	DEK	FJS	J6650	---	07-28-09
DRAWING TITLE / DESCRIPTION					DRAWING NUMBER
CONNECTING LINK					GD-J6650