

SECTION "A-A"

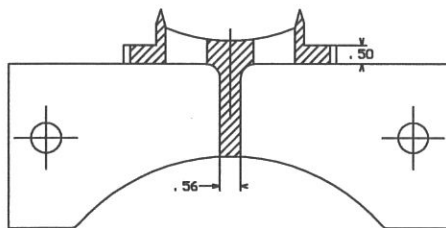

SECTION "R-R"

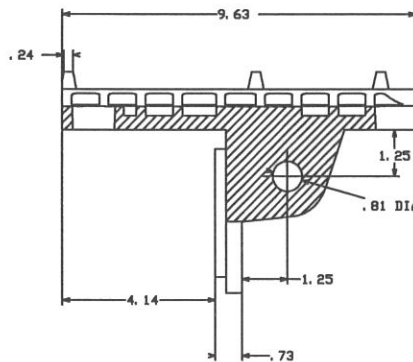

SECTION "C-C"

-NOTES-

1. MAT'L: DUCTILE IRON PER ASTM A536 (LATEST REVISION), GRADE 60-40-18.
2. HOT DIP GALVANIZE PER ASTM A153 (LATEST REVISION).

<p><b>CHANCE</b> TOLERANCE CHART</p> <p><small>X ± .005 FRACTION 1/16 ANGLES ±2° XX ± .005 ADD DRAFT UNLESS NOTED XXX ± .005 CASTING 3° FORGINGS 7°</small></p>		<p><b>HUBBELL</b> POWER SYSTEMS</p> <p>POWER SYSTEMS, INC.</p>	
<p>CONFIDENTIAL: THIS DRAWING AND ITS CONTENTS ARE CONFIDENTIAL AND THE EXCLUSIVE PROPERTY OF HUBBELL POWER SYSTEMS. NO PUBLICATION, DISTRIBUTION OR COPIES MAY BE MADE WITHOUT THE WRITTEN CONSENT OF HUBBELL POWER SYSTEMS. HUBBELL POWER SYSTEMS UNPUBLISHED. ALL RIGHTS RESERVED UNDER THE COPYRIGHT LAWS.</p>			
<p>TITLE: SHELF GAIN</p>			
SIZE	DWG NO.	CAT / PART / ASSY NO.	REV
B	SAPG84XE12	PG84XE12	---
DO NOT SCALE THIS DRAWING	DRN BY BERGER	DATE 10/26/12	SHEET 01 OF 01