

STATION POST

CAT. NO. PSP-210P

34.5 kV 200 kV BIL

ANSI PSP-210P

DIMENSIONS:

LEAKAGE DISTANCE IN 43.9

MECHANICAL VALUES:

CANTILEVER STRENGTH LB 2,000
 TENSION STRENGTH LB 10,000
 TORSION STRENGTH IN-LB 6,000
 COMPRESSION STRENGTH LB 10,000

ELECTRICAL VALUES:

IMPULSE FLASHOVER-POSITIVE kV 225
 60 HERTZ WITHSTAND-WET kV 80
 IMPULSE WITHSTAND kV 200

RADIO INFLUENCE VOLTAGE DATA:

60 HERTZ TEST VOLTAGE TO GROUND kV 22
 MAXIMUM R.I.V. @ 1000 kHz μV 100

- 1 ENG. MGR
- 2 ENG
- PURCH.
- 1 MKTG.
- PLT.MGR.
- COST
- PRD.
- INSP
- GLAZE
- BUSHING
- MAKING
- SHIP
- ASSEM
- MODEL
- MACH.
- 45
- TOOLING
- CER LAB
- 1 EL LAB
- 1 E.MEDIA

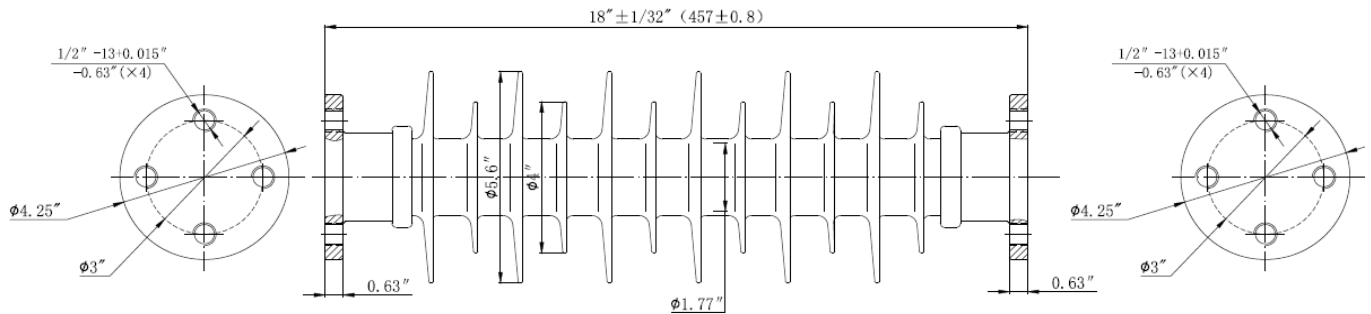

THIS DRAWING IS THE PROPERTY OF VICTOR INSULATORS, INC. AND CONTAINS PROPRIETARY AND CONFIDENTIAL INFORMATION WHICH MUST NOT BE DUPLICATED, USED, OR DISCLOSED OTHER THAN AS EXPRESSLY AUTHORIZED BY VICTOR INSULATORS, INC.

APPROVED
 By A. E. Schwalm at 1:32 pm, Nov 06, 2017

11-06-17	TM	 <p>Victor Insulators, Inc. 280 Maple Avenue Victor, New York 14564 Telephone: (585)924-2127 www.victorinsulators.com</p>	PSP-210P
04-05-16	TM		
10-03-12	TM		