

| 6 | 11 | 5 WIRE / CONDUCTOR SIZE | | | STUD SIZE | NO. OF HOLES | STUD HOLE DIAMETER (K) | FIG. | OUTSIDE DIAMETER (OD) | BARREL LENGTH (B) | PAD WIDTH (C) | PAD LENGTH (D) | HOLE SPACING (E & F) | OVERALL LENGTH (L) | HOLE OFFSET (N) | PAD THICKNESS (T) | HEIGHT (H) | COLOR CODE | DIE INDEX | WIRE STRIP LENGTH | 4 TEMP RATING |
|----------|---------|-------------------------|--------|------|-----------|--------------|------------------------|----------|-----------------------|-------------------|---------------|----------------|----------------------|--------------------|-----------------|-------------------|------------|------------|-----------|-------------------|---------------|
| | | ALUMINUM | COPPER | CCA | | | | | | | | | | | | | | | | | |
| YA8CA1 | #8 AWG | #8 AWG | | 10 | 1 | .20 [5] | 1 | .30 [8] | .62 [16] | .53 [13] | .60 [15] | | 1.50 [38] | .20 [5] | .09 [2] | | BLUE | 374 | 3/4" | 75°C | |
| YA8CA3 | #8 AWG | #8 AWG | | 1/4 | 1 | .28 [7] | 1 | .30 [8] | .62 [16] | .53 [13] | .75 [19] | | 1.65 [42] | .25 [6] | .09 [2] | | BLUE | 374 | 3/4" | 75°C | |
| YA6CA1 | #6 AWG | #6 AWG | | 1/4 | 1 | .28 [7] | 1 | .34 [9] | .75 [19] | .47 [12] | .75 [19] | | 1.84 [47] | .33 [8] | .14 [4] | | GRAY | 346 | 7/8" | 90°C | |
| YA6CA3 | #6 AWG | #6 AWG | | 3/8 | 1 | .44 [11] | 1 | .34 [9] | .75 [19] | .65 [17] | 1.19 [30] | | 2.28 [58] | .44 [11] | .09 [2] | | GRAY | 346 | 7/8" | 90°C | |
| YA4CA1 | #4 AWG | #4 AWG | | 1/4 | 1 | .28 [7] | 1 | .43 [11] | .88 [22] | .47 [12] | .75 [19] | | 2.13 [54] | .33 [8] | .18 [5] | | GREEN | 375 | 1" | 90°C | |
| YA4CA3 | #4 AWG | #4 AWG | | 5/16 | 1 | .38 [10] | 1 | .43 [11] | .88 [22] | .80 [20] | .87 [22] | | 2.25 [57] | .41 [10] | .12 [3] | | GREEN | 375 | 1" | 90°C | |
| YA4CA6 | #4 AWG | #4 AWG | | 3/8 | 1 | .44 [11] | 1 | .43 [11] | .88 [22] | .80 [20] | .94 [24] | | 2.32 [59] | .44 [11] | .12 [3] | | GREEN | 375 | 1" | 90°C | |
| YA4CA8 | #4 AWG | #4 AWG | | 1/2 | 2 | .56 [14] | 2 | .43 [11] | .88 [22] | .88 [22] | 3.11 [79] | 1.75 [44] | 4.50 [114] | .63 [16] | .11 [3] | | GREEN | 375 | 1" | 90°C | |
| YA2CA1 | #2 AWG | #2 AWG | | 5/16 | 1 | .38 [10] | 1 | .53 [13] | .53 [13] | .53 [13] | .88 [22] | | 2.50 [64] | .53 [13] | .53 [13] | | PINK | 348 | 1-1/4" | 90°C | |
| YA2CA3 | #2 AWG | #2 AWG | | 3/8 | 1 | .44 [11] | 1 | .53 [13] | 1.12 [28] | .88 [22] | .94 [24] | | 2.56 [65] | .44 [11] | .16 [4] | | PINK | 348 | 1-1/4" | 90°C | |
| YA2CA5 | #2 AWG | #2 AWG | | 1/4 | 1 | .28 [7] | 1 | .53 [13] | 1.00 [25] | .50 [13] | .75 [19] | | 2.25 [57] | .33 [8] | .22 [6] | | PINK | 348 | 1-1/4" | 90°C | |
| YA2CA9 | #2 AWG | #2 AWG | | 1/2 | 2 | .56 [14] | 2 | .53 [13] | 1.12 [28] | .88 [22] | 3.11 [79] | 1.75 [44] | 4.73 [120] | .63 [16] | .16 [4] | | PINK | 348 | 1-1/4" | 90°C | |
| YA1CA1 | #1 AWG | #1 AWG | | 3/8 | 1 | .44 [11] | 1 | .54 [14] | .91 [23] | .76 [19] | 1.19 [30] | | 2.59 [66] | .44 [11] | .19 [5] | | GOLD | 471 | 1-1/16" | 90°C | |
| YA1CA3 | #1 AWG | #1 AWG | | 1/4 | 1 | .28 [7] | 1 | .54 [14] | .91 [23] | .52 [13] | .75 [19] | | 2.16 [55] | .33 [8] | .19 [5] | | GOLD | 471 | 1-1/16" | 90°C | |
| YA1CA4 | #1 AWG | #1 AWG | | 5/16 | 1 | .38 [10] | 1 | .54 [14] | .91 [23] | .76 [19] | .81 [21] | | 2.25 [57] | .41 [10] | .19 [5] | | GOLD | 471 | 1-1/16" | 90°C | |
| YA1CA9 | #1 AWG | #1 AWG | | 1/2 | 2 | .56 [14] | 2 | .54 [14] | .91 [23] | .88 [22] | 3.11 [79] | 1.75 [44] | 4.52 [115] | .63 [16] | .19 [5] | | GOLD | 471 | 1-1/16" | 90°C | |
| YA25A1 | 1/0 AWG | 1/0 AWG | | 5/16 | 1 | .38 [10] | 1 | .60 [15] | 1.00 [25] | .60 [15] | .87 [22] | | 2.31 [59] | .41 [10] | .21 [5] | | TAN | 296 | 1-3/16" | 90°C | |
| YA25A3 | 1/0 AWG | 1/0 AWG | | 3/8 | 1 | .44 [11] | 1 | .60 [15] | 1.05 [27] | .82 [21] | 1.18 [30] | | 2.67 [68] | .63 [16] | .21 [5] | | TAN | 296 | 1-3/16" | 90°C | |
| YA25A5 | 1/0 AWG | 1/0 AWG | | 3/8 | 2 | .44 [11] | 2 | .60 [15] | 1.05 [27] | .82 [21] | 2.24 [57] | 1.06 [27] | 3.73 [95] | .63 [16] | .21 [5] | | TAN | 296 | 1-3/16" | 90°C | |
| YA25A7 | 1/0 AWG | 1/0 AWG | | 1/2 | 2 | .56 [14] | 2 | .60 [15] | 1.05 [27] | 1.03 [26] | 3.10 [79] | | 4.59 [117] | .63 [16] | .17 [4] | | TAN | 296 | 1-3/16" | 90°C | |
| YA25A790 | 1/0 AWG | 1/0 AWG | | 1/2 | 2 | .56 [14] | 4 | .60 [15] | 1.05 [27] | 1.03 [26] | 3.10 [79] | 1.75 [44] | 3.44 [87] | .63 [16] | .17 [4] | 1.70 [43] | TAN | 296 | 1-3/16" | 90°C | |
| YA25A9 | 1/0 AWG | 1/0 AWG | | 1/2 | 1 | .56 [14] | 1 | .60 [15] | 1.05 [27] | 1.03 [26] | 1.34 [34] | | 2.83 [72] | .63 [16] | .17 [4] | | TAN | 296 | 1-3/16" | 90°C | |

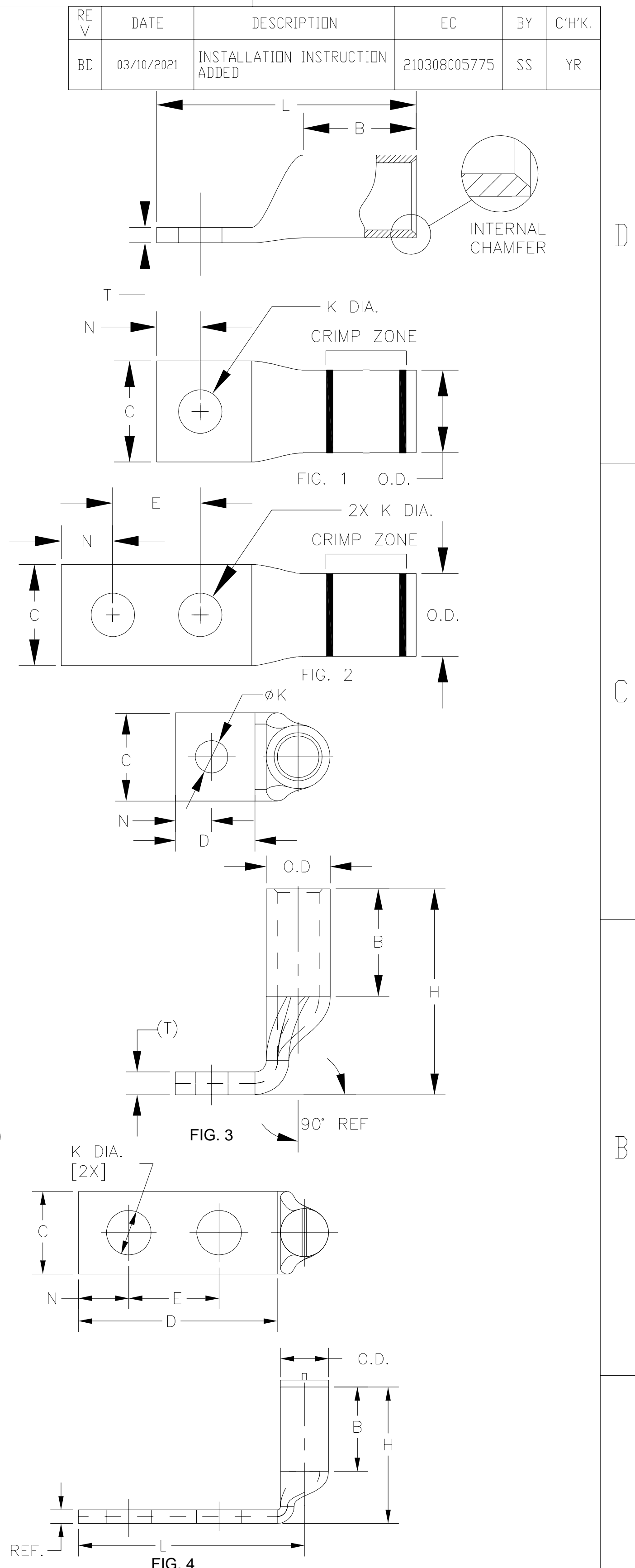

NOTES:

- CONNECTOR: UNINSULATED ALUMINUM COMPRESSION TERMINAL. MADE FROM SEAMLESS ALUMINUM TUBING.
- CONNECTION: COMPRESSION CONNECTIONS MADE ARE IRREVERSIBLE AND MAINTENANCE FREE.
- APPLICABLE STANDARDS: PRODUCTS ARE ONLY UL LISTED AND CSA CERTIFIED WHEN INSTALLED USING THE BURNDY ENGINEERED SYSTEM: TOOLS, DIES (IF APPLICABLE), AND CONNECTORS. THE USE OF OTHER INDUSTRY TOOLING AND OR DIES ON BURNDY CONNECTORS WILL VOID THE UL LISTING AND CSA CERTIFICATIONS.
 - UL LISTING TO UL486A-486B-WIRE CONNECTORS
 - CSA C22.2
- TEMPERATURE AND VOLTAGE RATING:
 - UL LISTED 90°C OR 75°C, UP TO 35kV *SEE CONNECTOR FINISHES FOR ADDITIONAL SERVICE TEMPERATURE RATINGS.
 - ALUMINUM CONNECTORS MARKED AL9CU ACCOMMODATE ALUMINUM (AL) AND COPPER (CU) CODE WIRE UP TO 90°C.
 - ALUMINUM CONNECTORS MARKED AL7CU ACCOMMODATE ALUMINUM (AL) AND COPPER (CU) CODE WIRE UP TO 75°C.
- WIRE ACCOMMODATE TYPES (SEE TABLE): DUAL RATED TO ACCOMMODATE ALUMINUM AND COPPER WIRE.
 - CODE ALUMINUM WIRE (CU): CLASS B (CONCENTRIC, COMPRESS, COMPACT) STRANDING.
 - CODE COPPER WIRE (AL): CLASS B (CONCENTRIC, COMPRESS, COMPACT) OR CLASS C STRANDING.
 - COPPER CLAD ALUMINUM (CCA) STRANDING: SEE TABLE FOR SELECT TERMINALS AND APPLICABLE CCA WIRE SIZES.
- CONNECTOR FINISHES AND SUFFIX: SEE SECTION C OF THE BURNDY MASTER CATALOG FOR PLATING SERVICE TEMPERATURE RATINGS.
 - ELECTRO-TIN PLATED: CONNECTORS HAVING NO SUFFIX ARE TIN PLATED UNLESS OTHERWISE SPECIFIES. CATALOG NUMBER EXAMPLE: YA34A3.
 - NICKEL PLATED: APPLY SUFFIX "NK" TO A CATALOG NUMBER IN THE TABLE, IF NOT SPECIFIED. CATALOG NUMBER EXAMPLE: YA34A3NK.
 - SILVER PLATED: APPLY SUFFIX "SV" TO A CATALOG NUMBER IN THE TABLE, IF NOT SPECIFIED. CATALOG NUMBER EXAMPLE: YA34A3SV.
 - TIN ZINC : APPLY SUFFIX "TZ" TO A CATALOG NUMBER IN THE TABLE, IF NOT SPECIFIED. CATALOG NUMBER EXAMPLE: YA34A3TZ.
 - BARE CONNECTORS: APPLYING SUFFIX "BR" TO A CATALOG NUMBER IN THE TABLE, IF NOT SPECIFIED. CATALOG NUMBER EXAMPLE: YA343BR.
- FEATURES:
 - BARREL TYPICAL ROLL MARKINGS (AS SPACE PERMITS): CRIMP ZONE IS INDICATED BY KNURL BANDS, BURNDY CORPORATE NAME OR LOGO, UL LOGO (IF APPLICABLE), CSA LOGO (IF APPLICABLE), WIRE SIZE, DIE COLOR CODE (IF SPACE PERMITS), DIE INDEX NUMBER.
 - BARREL DESIGN: BARREL END AT THE WIRE HAS AN INTERNAL CHAMFER, ALLOWING FOR A SMOOTH WIRE INSERTION.
 - TERMINALS ARE PRE-FILLED WITH PENETROX™ A13, WHICH IS AN OXIDE INHIBITOR.
 - EACH TERMINAL HAS A COLOR-CODED END CAP TO MATCH THE DIE COLOR CODE. THIS ALSO PREVENTS PARTICLES FROM ENTERING THE BARREL.
 - PAD/TONGUE/TANG/SPADE DESIGN: ONE-HOLE, TWO-HOLE, AND FOUR HOLE DESIGNS. CONTACT CUSTOMER SERVICE FOR ALTERNATE PAD CONFIGURATIONS.
 - FIELD BENDING STRAIGHT LUGS TO ACHIEVE AN ANGULAR CONNECTION WILL VOID ALL APPLICABLE STANDARDS LISTED IN NOTE 2.
 - CATALOG NUMBER SUFFIX DT OR DTS: INDICATES THAT THE TRANSITION IN THE TERMINAL BETWEEN THE PAD AND BARREL ARE SOLDER OR BRAZE SEALED TO BE OIL TIGHT INSIDE THE BARREL. THIS PREVENTS ANY LIQUIDS FROM EXITING OR ENTERING THE BARREL THROUGH THE PAD.
 - IF NOT LISTED IN THE TABLE, PLEASE CONTACT CUSTOMER SERVICE FOR 45°, 90°, AND OR OTHER ANGULAR LUGS FOR PRODUCT AVAILABILITY. CATALOG NUMBER SUFFIX 45 INDICATES THAT THE TERMINAL IS BENT AT A 45 DEGREE ANGLE. CATALOG NUMBER SUFFIX 90 INDICATES THAT THE TERMINAL IS BENT AT A 90 DEGREE ANGLE.
- INSTALLATION TOOLING AND DIES ARE CONSTANTLY BEING UPDATED. PLEASE SEE BURNDY MASTER CATALOG FOR THIS PRODUCT FAMILY, WHICH CAN BE FOUND ON THE BURNDY WEBSITE.
- SPECIAL REQUIREMENTS:
 - YA39A- CONNECTORS: 900 KCMIL CLASS B COMPACT WIRE REQUIRES THE USE OF THE 644 SERIES OR 444 SERIES DIE-LESS INSTALLATION TOOLS AND 2 CRIMPS.
 - YA42A- CONNECTORS: 600 KCMIL CU REQUIRES THE USE OF THE 644 SERIES OR 444 SERIES DIE-LESS INSTALLATION TOOLS.
 - YA44A- CONNECTORS ACCOMMODATE 1100 KCMIL WIRE CLASS A AND CLASS B COMPACT, BUT IS NOT UL LISTED OR CSA CERTIFIED.
- DIMENSIONS IN BRACKETS [] ARE IN MILLIMETERS ROUNDED OFF TO THE NEAREST MILLIMETER, UNLESS OTHERWISE SPECIFIED AND ARE FOR REFERENCE ONLY.
- CATALOG NUMBER SCHEME: EX: YA34A3.
 - Y = COMPRESSION, A = TERMINAL, 34 = WIRE SIZE (500 KCMIL), A = ALUMINUM CONNECTOR, 3 = HOLE SIZE AND PATTERN.

- TYPICAL MARKINGS:
- BURNDY COMPANY IDENTIFIER
 - UL LOGO, IF APPLICABLE
 - CSA LOGO, IF APPLICABLE
 - BURNDY CATALOG NUMBER
 - WIRE ACCOMMODATES
 - COLOR CODE IDENTIFIER
 - DIE INDEX NUMBER
 - CRIMP ZONE BANDS (KNURL MARKS)

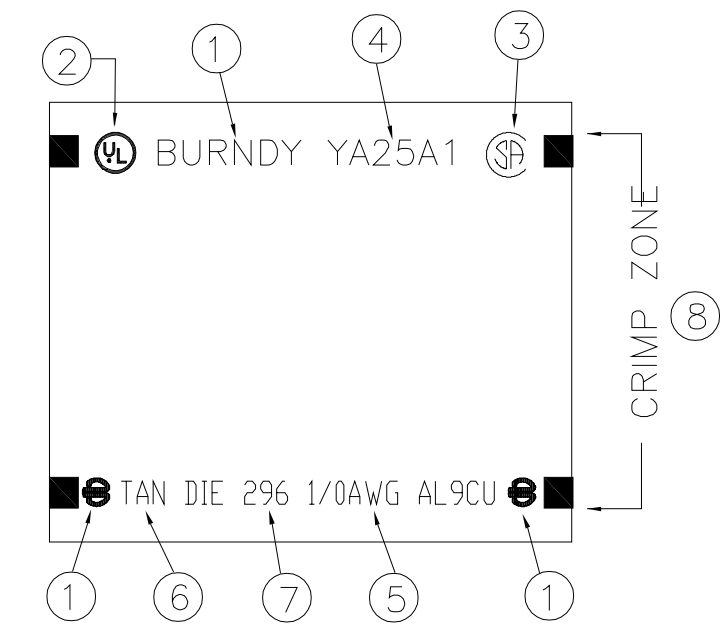

TO ORDER BURNDY® PRODUCTS CALL
 UNITED STATES
 1-800-346-4175 (LONDONDERRY, NH)
 CANADA:
 1-800-361-6975 (QUEBEC)
 1-800-387-6487 (ALL OTHER PROVINCES)
 FOR PRODUCT INFO: <http://www.burndy.com>

| HYLUG™ | | SCALE | NTS |
|----------------|---------------------|---------------|-----|
| ITEM NO: | N/A | | |
| CAT. NO: | YABCA - (SEE TABLE) | | |
| DRAWN BY: | E.S.K. 7/19/72 | | |
| CHECKER: | S.F.P. 8/01/72 | | |
| DSN APPVL: | R.B. 8/02/72 | | |
| MFG APPVL: | -- | | |
| QA APPVL: | D. VARID 6/19/95 | | |
| MKT APPVL: | -- | | |
| PROD FAM: | CM&R COMPRESSION | DRAWING NO | REV |
| PROJECT #: | SIZE | SD.073935 | BD |
| DOCUMENT TYPE: | Sales | | |
| REL LEVEL: | Released | SHEET 1 OF 10 | |

| 6 CATALOG NUMBER | 5 WIRE / CONDUCTOR SIZE | | | STUD SIZE | NO. OF HOLES | STUD HOLE DIAMETER (K) | FIG. | OUTSIDE DIAMETER (OD) | BARREL LENGTH (B) | PAD WIDTH (C) | PAD LENGTH (D) | HOLE SPACING (E & F) | OVERALL LENGTH (L) | HOLE OFFSET (N) | PAD THICKNESS (T) | HEIGHT (H) | COLOR CODE | DIE INDEX | WIRE STRIP LENGTH | 4 TEMP RATING |
|---------------------|----------------------------|-----------|------------------------|-----------|--------------|------------------------|------|-----------------------|-------------------|---------------|----------------|----------------------|--------------------|-----------------|-------------------|------------|------------|-----------|-------------------|------------------|
| | ALUMINUM | COPPER | CCA | | | | | | | | | | | | | | | | | |
| YA26A1 | 2/0 AWG | 2/0 AWG | | 1/2 | 1 | .56 [14] | 1 | .67 [17] | 1.17 [30] | 1.03 [26] | 1.36 [35] | | 3.03 [77] | .20 [5] | .20 [5] | | OLIVE | 297 | 1-3/8" | 90°C |
| YA26A6 | 2/0 AWG | 2/0 AWG | | 3/8 | 1 | .44 [11] | 1 | .67 [17] | 1.17 [30] | .67 [17] | 1.18 [30] | | 2.79 [71] | .25 [6] | .24 [6] | | OLIVE | 297 | 1-3/8" | 90°C |
| YA26A7 | 2/0 AWG | 2/0 AWG | | 5/16 | 1 | .38 [10] | 1 | .67 [17] | 1.17 [30] | .67 [17] | .81 [21] | | 2.52 [64] | .33 [8] | .24 [6] | | OLIVE | 297 | 1-3/8" | 90°C |
| YA26A8 | 2/0 AWG | 2/0 AWG | | 5/8 | 1 | .69 [18] | 1 | .67 [17] | 1.17 [30] | 1.03 [26] | 1.36 [35] | | 3.03 [77] | .44 [11] | .20 [5] | | OLIVE | 297 | 1-3/8" | 90°C |
| YA26A3 | 2/0 AWG | 2/0 AWG | | 1/2 | 2 | .56 [18] | 2 | .67 [17] | 1.17 [30] | 1.03 [26] | 3.11 [79] | 1.75 [44] | 4.78 [121] | .33 [8] | .20 [5] | | OLIVE | 297 | 1-3/8" | 90°C |
| YA26A5 | 2/0 AWG | 2/0 AWG | | 3/8 | 2 | .44 [11] | 2 | .67 [17] | 1.17 [30] | .92 [23] | 1.89 [48] | 1.00 [25] | 3.56 [90] | .41 [10] | .24 [6] | | OLIVE | 297 | 1-3/8" | 90°C |
| YA27A1 | 3/0 AWG | 3/0 AWG | | 3/8 | 1 | .44 [11] | 1 | .76 [19] | 1.11 [28] | .73 [19] | 1.18 [30] | | 2.88 [73] | .44 [11] | .26 [7] | | RUBY | 467 | 1-1/2" | 90°C |
| YA27A3 | 3/0 AWG | 3/0 AWG | | 1/2 | 1 | .58 [14] | 1 | .79 [19] | 1.31 [33] | 1.04 [26] | 1.37 [35] | | 3.27 [83] | .63 [16] | .26 [7] | | RUBY | 467 | 1-1/2" | 90°C |
| YA27A5 | 3/0 AWG | 3/0 AWG | | 1/2 | 2 | .56 [14] | 2 | .79 [19] | 1.31 [33] | 1.04 [26] | 3.12 [79] | 1.75 [44] | 5.02 [128] | .63 [16] | .26 [7] | | RUBY | 467 | 1-1/2" | 90°C |
| YA27A7 | 3/0 AWG | 3/0 AWG | | 3/8 | 2 | .44 [11] | 2 | .79 [19] | 1.31 [33] | 1.04 [26] | 1.89 [48] | 1.00 [25] | 3.79 [96] | .44 [11] | .26 [7] | | RUBY | 467 | 1-1/2" | 90°C |
| YA28A1 | 4/0 AWG | 4/0 AWG | | 3/8 | 1 | .44 [11] | 1 | .85 [22] | 1.39 [35] | 1.17 [30] | 1.18 [30] | | 3.26 [83] | .44 [11] | .30 [8] | | WHITE | 298 | 1-5/8" | 90°C |
| YA28A3 | 4/0 AWG | 4/0 AWG | | 1/2 | 1 | .56 [14] | 1 | .85 [22] | 1.39 [35] | 1.17 [30] | 1.36 [35] | | 3.44 [87] | .63 [16] | .30 [8] | | WHITE | 298 | 1-5/8" | 90°C |
| YA28A5 | 4/0 AWG | 4/0 AWG | | 1/2 | 2 | .56 [14] | 2 | .85 [22] | 1.39 [35] | 1.17 [30] | 3.11 [79] | 1.75 [44] | 5.19 [132] | .63 [16] | .30 [8] | | WHITE | 298 | 1-5/8" | 90°C |
| YA28A7 | 4/0 AWG | 4/0 AWG | | 3/8 | 2 | .44 [11] | 2 | .85 [22] | 1.39 [35] | 1.17 [30] | 1.89 [48] | 1.00 [25] | 3.97 [101] | .44 [11] | .30 [8] | | WHITE | 298 | 1-5/8" | 90°C |
| YA28A590 | 4/0 AWG | 4/0 AWG | | 1/2 | 2 | .56 [14] | 4 | .85 [22] | 1.39 [35] | 1.17 [30] | 3.11 [79] | 1.75 [44] | 3.63 [98] | .63 [16] | .30 [8] | 2.73 [69] | WHITE | 298 | 1-5/8" | 90°C |
| YA29A1 | 250 KCMIL | 250 KCMIL | | 1/2 | 1 | .56 [14] | 1 | .92 [37] | 1.45 [37] | 1.26 [32] | 1.36 [35] | | 3.53 [90] | .63 [16] | .33 [8] | | RED | 324 | 1-5/8" | 90°C |
| YA29A6 | 250 KCMIL | 250 KCMIL | | 5/8 | 1 | .69 [18] | 1 | .92 [37] | 1.45 [37] | 1.26 [32] | 1.52 [39] | | 3.69 [94] | .75 [19] | .33 [8] | | RED | 324 | 1-5/8" | 90°C |
| YA29A3 | 250 KCMIL | 250 KCMIL | | 1/2 | 2 | .56 [14] | 2 | .92 [37] | 1.45 [37] | 1.26 [32] | 3.11 [79] | 1.75 [44] | 5.28 [134] | .63 [16] | .33 [8] | | RED | 324 | 1-5/8" | 90°C |
| YA29A5 | 250 KCMIL | 250 KCMIL | | 3/8 | 2 | .44 [11] | 2 | .92 [37] | 1.45 [37] | 1.26 [32] | 1.89 [48] | 1.00 [25] | 4.06 [103] | .44 [11] | .33 [8] | | RED | 324 | 1-5/8" | 90°C |
| YA30A1 | 300 KCMIL | 300 KCMIL | 4/0 AWG DLO (329/22) | 1/2 | 1 | .56 [14] | 1 | 1.01 [26] | 1.53 [39] | 1.38 [35] | 1.37 [35] | | 3.90 [99] | .63 [16] | .36 [9] | | BLUE | 470 | 1-3/4" | 90°C |
| YA30A6 | 300 KCMIL | 300 KCMIL | 4/0 AWG DLO (329/22) | 3/8 | 1 | .44 [11] | 1 | 1.01 [26] | 1.53 [39] | 1.38 [35] | 1.37 [35] | | 3.90 [99] | .63 [16] | .36 [9] | | BLUE | 470 | 1-3/4" | 90°C |
| YA30A3 | 300 KCMIL | 300 KCMIL | 4/0 AWG DLO (329/22) | 1/2 | 2 | .56 [14] | 2 | 1.01 [26] | 1.53 [39] | 1.38 [35] | 3.11 [79] | 1.75 [44] | 5.64 [143] | .63 [16] | .36 [9] | | BLUE | 470 | 1-3/4" | 90°C |
| YA30A5 | 300 KCMIL | 300 KCMIL | 4/0 AWG DLO (329/22) | 3/8 | 2 | .44 [11] | 2 | 1.01 [26] | 1.53 [39] | 1.38 [35] | 1.89 [48] | 1.00 [25] | 4.42 [112] | .44 [11] | .36 [9] | | BLUE | 470 | 1-3/4" | 90°C |
| YA31A1 | 350 KCMIL | 350 KCMIL | 250 KCMIL DLO (399/22) | 1/2 | 1 | .56 [14] | 1 | 1.11 [28] | 1.85 [47] | 1.52 [39] | 1.37 [35] | | 4.53 [110] | .63 [16] | .39 [10] | | BROWN | 299 | 2-1/8" | 90°C |
| YA31A6 | 350 KCMIL | 350 KCMIL | 250 KCMIL DLO (399/22) | 3/8 | 1 | .44 [11] | 1 | 1.11 [28] | 1.85 [47] | 1.52 [39] | .89 [23] | | 3.85 [98] | .44 [11] | .39 [10] | | BROWN | 299 | 2-1/8" | 90°C |
| YA31A12 | 350 KCMIL | 350 KCMIL | 250 KCMIL DLO (399/22) | 5/8 | 1 | .65 [17] | 1 | 1.11 [28] | 1.85 [47] | 1.52 [39] | 1.37 [35] | | 4.33 [110] | .63 [16] | .39 [10] | | BROWN | 299 | 2-1/8" | 90°C |
| YA31A190 | 350 KCMIL | 350 KCMIL | 250 KCMIL DLO (399/22) | 1/2 | 1 | .56 [14] | 3 | 1.11 [28] | 1.85 [47] | 1.52 [39] | 1.37 [35] | | 2.12 [54] | .63 [16] | .39 [10] | 3.74 [95] | BROWN | 299 | 2-1/8" | 90°C |
| YA31A3 | 350 KCMIL | 350 KCMIL | 250 KCMIL DLO (399/22) | 1/2 | 2 | .56 [14] | 2 | 1.11 [28] | 1.85 [47] | 1.52 [39] | 3.11 [79] | 1.75 [44] | 6.07 [154] | .63 [16] | .39 [10] | | BROWN | 299 | 2-1/8" | 90°C |
| YA31A5 | 350 KCMIL | 350 KCMIL | 250 KCMIL DLO (399/22) | 3/8 | 2 | .44 [11] | 2 | 1.11 [28] | 1.85 [47] | 1.52 [39] | 1.89 [48] | 1.00 [25] | 4.85 [123] | .44 [11] | .39 [10] | | BROWN | 299 | 2-1/8" | 90°C |
| YA31A390 | 350 KCMIL | 350 KCMIL | 250 KCMIL DLO (399/22) | 1/2 | 2 | .56 [14] | 4 | 1.11 [28] | 1.85 [47] | 1.52 [39] | 3.11 [79] | 1.75 [44] | 3.87 [98] | .63 [16] | .39 [10] | 3.74 [95] | BROWN | 299 | 2-1/8" | 90°C |

NOTES:

- CONNECTOR: UNINSULATED ALUMINUM COMPRESSION TERMINAL. MADE FROM SEAMLESS ALUMINUM TUBING.
- CONNECTION: COMPRESSION CONNECTIONS MADE ARE IRREVERSIBLE AND MAINTENANCE FREE.
- APPLICABLE STANDARDS: PRODUCTS ARE ONLY UL LISTED AND CSA CERTIFIED WHEN INSTALLED USING THE BURNDY ENGINEERED SYSTEM: TOOLS, DIES (IF APPLICABLE), AND CONNECTORS. THE USE OF OTHER INDUSTRY TOOLING AND OR DIES ON BURNDY CONNECTORS WILL VOID THE UL LISTING AND CSA CERTIFICATIONS.
 - UL LISTING TO UL486A-486B-WIRE CONNECTORS
 - CSA C22.2
- TEMPERATURE AND VOLTAGE RATING:
 - UL LISTED 90°C OR 75°C, UP TO 35kV *SEE CONNECTOR FINISHES FOR ADDITIONAL SERVICE TEMPERATURE RATINGS.
 - ALUMINUM CONNECTORS MARKED AL9CU ACCOMMODATE ALUMINUM (AL) AND COPPER (CU) CODE WIRE UP TO 90°C.
 - ALUMINUM CONNECTORS MARKED AL7CU ACCOMMODATE ALUMINUM (AL) AND COPPER (CU) CODE WIRE UP TO 75°C.
- WIRE ACCOMMODATE TYPES (SEE TABLE): DUAL RATED TO ACCOMMODATE ALUMINUM AND COPPER WIRE.
 - CODE ALUMINUM WIRE (CU): CLASS B (CONCENTRIC, COMPRESS, COMPACT) STRANDING.
 - CODE COPPER WIRE (AL): CLASS B (CONCENTRIC, COMPRESS, COMPACT) OR CLASS C STRANDING.
 - COPPER CLAD ALUMINUM (CCA) STRANDING: SEE TABLE FOR SELECT TERMINALS AND APPLICABLE CCA WIRE SIZES.
- CONNECTOR FINISHES AND SUFFIX: SEE SECTION C OF THE BURNDY MASTER CATALOG FOR PLATING SERVICE TEMPERATURE RATINGS.
 - ELECTRO-TIN PLATED: CONNECTORS HAVING NO SUFFIX ARE TIN PLATED UNLESS OTHERWISE SPECIFIES. CATALOG NUMBER EXAMPLE: YA34A3.
 - NICKEL PLATED: APPLY SUFFIX "NK" TO A CATALOG NUMBER IN THE TABLE, IF NOT SPECIFIED. CATALOG NUMBER EXAMPLE: YA34A3NK.
 - SILVER PLATED: APPLY SUFFIX "SV" TO A CATALOG NUMBER IN THE TABLE, IF NOT SPECIFIED. CATALOG NUMBER EXAMPLE: YA34A3SV.
 - TIN ZINC : APPLY SUFFIX "TZ" TO A CATALOG NUMBER IN THE TABLE, IF NOT SPECIFIED. CATALOG NUMBER EXAMPLE: YA34A3TZ.
 - BARE CONNECTORS: APPLYING SUFFIX "BR" TO A CATALOG NUMBER IN THE TABLE, IF NOT SPECIFIED. CATALOG NUMBER EXAMPLE: YA343BR.
- FEATURES:
 - BARREL TYPICAL ROLL MARKINGS (AS SPACE PERMITS): CRIMP ZONE IS INDICATED BY KNURL BANDS, BURNDY CORPORATE NAME OR LOGO, UL LOGO (IF APPLICABLE), CSA LOGO (IF APPLICABLE), WIRE SIZE, DIE COLOR CODE (IF SPACE PERMITS), DIE INDEX NUMBER.
 - BARREL DESIGN: BARREL END AT THE WIRE HAS AN INTERNAL CHAMFER, ALLOWING FOR A SMOOTH WIRE INSERTION.
 - TERMINALS ARE PRE-FILLED WITH PENETROX™ A13, WHICH IS AN OXIDE INHIBITOR.
 - EACH TERMINAL HAS A COLOR-CODED END CAP TO MATCH THE DIE COLOR CODE. THIS ALSO PREVENTS PARTICLES FROM ENTERING THE BARREL.
 - PAD/TONGUE/TANG/SPADE DESIGN: ONE-HOLE, TWO-HOLE, AND FOUR HOLE DESIGNS. CONTACT CUSTOMER SERVICE FOR ALTERNATE PAD CONFIGURATIONS.
 - FIELD BENDING STRAIGHT LUGS TO ACHIEVE AN ANGULAR CONNECTION WILL VOID ALL APPLICABLE STANDARDS LISTED IN NOTE 2.
 - CATALOG NUMBER SUFFIX DT OR DTS: INDICATES THAT THE TRANSITION IN THE TERMINAL BETWEEN THE PAD AND BARREL ARE SOLDER OR BRAZE SEALED TO BE OIL TIGHT INSIDE THE BARREL. THIS PREVENTS ANY LIQUIDS FROM EXITING OR ENTERING THE BARREL THROUGH THE PAD.
 - IF NOT LISTED IN THE TABLE, PLEASE CONTACT CUSTOMER SERVICE FOR 45°, 90°, AND OR OTHER ANGULAR LUGS FOR PRODUCT AVAILABILITY. CATALOG NUMBER SUFFIX 45 INDICATES THAT THE TERMINAL IS BENT AT A 45 DEGREE ANGLE. CATALOG NUMBER SUFFIX 90 INDICATES THAT THE TERMINAL IS BENT AT A 90 DEGREE ANGLE.
- INSTALLATION TOOLING AND DIES ARE CONSTANTLY BEING UPDATED. PLEASE SEE BURNDY MASTER CATALOG FOR THIS PRODUCT FAMILY, WHICH CAN BE FOUND ON THE BURNDY WEBSITE.
- SPECIAL REQUIREMENTS:
 - YA39A- CONNECTORS: 900 KCMIL CLASS B COMPACT WIRE REQUIRES THE USE OF THE 644 SERIES OR 444 SERIES DIE-LESS INSTALLATION TOOLS AND 2 CRIMPS.
 - YA42A- CONNECTORS: 600 KCMIL CU REQUIRES THE USE OF THE 644 SERIES OR 444 SERIES DIE-LESS INSTALLATION TOOLS.
 - YA44A- CONNECTORS ACCOMMODATE 1100 KCMIL WIRE CLASS A AND CLASS B COMPACT, BUT IS NOT UL LISTED OR CSA CERTIFIED.
- DIMENSIONS IN BRACKETS [] ARE IN MILLIMETERS ROUNDED OFF TO THE NEAREST MILLIMETER, UNLESS OTHERWISE SPECIFIED AND ARE FOR REFERENCE ONLY.
- CATALOG NUMBER SCHEME: EX: YA34A3.
 - Y = COMPRESSION, A = TERMINAL, 34 = WIRE SIZE (500 KCMIL), A = ALUMINUM CONNECTOR, 3 = HOLE SIZE AND PATTERN.

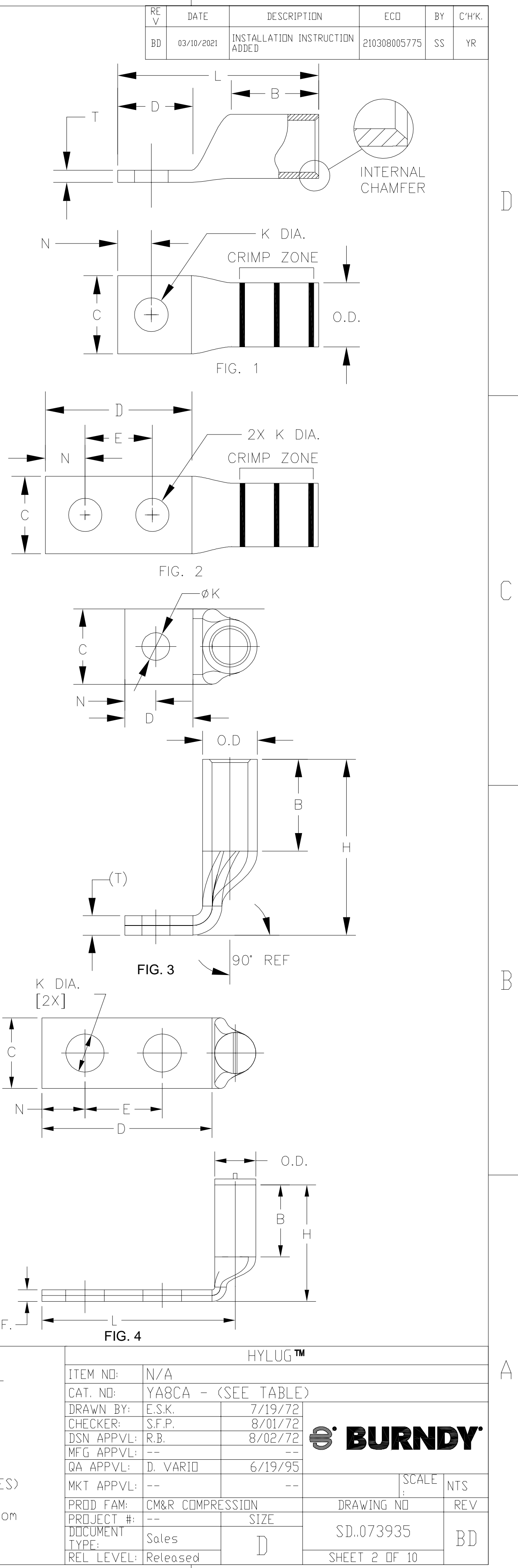

- TYPICAL MARKINGS:
- BURNDY COMPANY IDENTIFIER
 - UL LOGO, IF APPLICABLE
 - CSA LOGO, IF APPLICABLE
 - BURNDY CATALOG NUMBER
 - WIRE ACCOMMODATES
 - COLOR CODE IDENTIFIER
 - DIE INDEX NUMBER
 - CRIMP ZONE BANDS (KNURL MARKS)

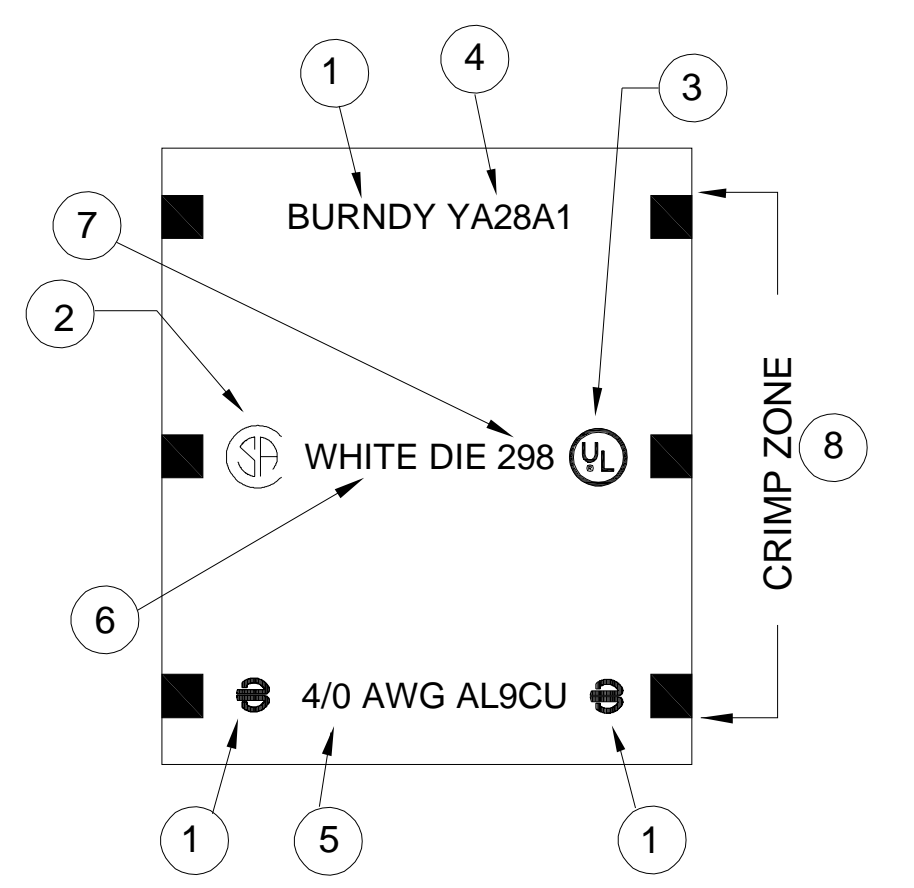

| 6 | 11 | 5 WIRE / CONDUCTOR SIZE | | | STUD SIZE | NO. OF HOLES | STUD HOLE DIAMETER (K) | FIG. | OUTSIDE DIAMETER (OD) | BARREL LENGTH (B) | PAD WIDTH (C) | PAD LENGTH (D) | HOLE SPACING (E >> F) | OVERALL LENGTH (L) | HOLE OFFSET (N) | PAD THICKNESS (T) | HEIGHT (H) | COLOR CODE | DIE INDEX | WIRE STRIP LENGTH | 4 TEMP RATING |
|-------------|-----------------------|-------------------------|------------------------|-----|-----------|--------------|------------------------|-----------|-----------------------|-------------------|---------------|----------------|-----------------------|--------------------|-----------------|-------------------|------------|------------|-----------|-------------------|---------------|
| | | ALUMINUM | COPPER | CCA | | | | | | | | | | | | | | | | | |
| YA32A1 | 400 KCMIL | 400 KCMIL | | 5/8 | 1 | .69 [18] | 1 | 1.19 [30] | 2.26 [57] | 1.60 [41] | 1.88 [48] | | 4.92 [125] | .88 [22] | .43 [11] | | GREEN | 472 | 2-1/2" | 90°C | |
| YA32A6 | 400 KCMIL | 400 KCMIL | | 1/2 | 1 | .56 [14] | 1 | 1.19 [30] | 2.26 [57] | 1.62 [41] | 1.88 [48] | | 4.92 [125] | .88 [22] | .43 [11] | | GREEN | 472 | 2-1/2" | 90°C | |
| YA32A3 | 400 KCMIL | 400 KCMIL | | 1/2 | 2 | .56 [14] | 2 | 1.19 [30] | 2.26 [57] | 1.62 [41] | 3.11 [79] | 1.75 [44] | 6.15 [156] | .63 [16] | .43 [11] | | GREEN | 472 | 2-1/2" | 90°C | |
| YA32A5 | 400 KCMIL | 400 KCMIL | | 3/8 | 2 | .44 [11] | 2 | 1.19 [30] | 2.26 [57] | 1.62 [41] | 1.89 [48] | 1.00 [25] | 4.93 [125] | .44 [11] | .43 [11] | | GREEN | 472 | 2-1/2" | 90°C | |
| YA34A1 | 500 KCMIL | 500 KCMIL | 350 KCMIL DLO (551/22) | 5/8 | 1 | .69 [18] | 1 | 1.32 [34] | 2.34 [59] | 1.80 [46] | 1.91 [49] | | 5.56 [141] | .88 [22] | .46 [12] | | PINK | 300 | 2-5/8" | 90°C | |
| YA34A7 | 500 KCMIL | 500 KCMIL | 350 KCMIL DLO (551/22) | 1/2 | 1 | .56 [14] | 1 | 1.32 [34] | 2.34 [59] | 1.80 [46] | 1.37 [35] | | 5.02 [128] | .63 [16] | .46 [12] | | PINK | 300 | 2-5/8" | 90°C | |
| YA34A3 | 500 KCMIL | 500 KCMIL | 350 KCMIL DLO (551/22) | 1/2 | 2 | .56 [14] | 2 | 1.32 [34] | 2.34 [59] | 1.62 [41] | 3.15 [80] | 1.75 [44] | 6.80 [173] | .63 [16] | .46 [12] | | PINK | 300 | 2-5/8" | 90°C | |
| YA34A8 | 500 KCMIL | 500 KCMIL | 350 KCMIL DLO (551/22) | 1/2 | 2 | .56 [14] | 2 | 1.32 [34] | 2.34 [59] | 1.80 [46] | 3.15 [80] | 1.75 [44] | 6.77 [172] | .63 [16] | .46 [12] | | PINK | 300 | 2-5/8" | 90°C | |
| YA34A5 | 500 KCMIL | 500 KCMIL | 350 KCMIL DLO (551/22) | 3/8 | 2 | .44 [11] | 2 | 1.32 [34] | 2.34 [59] | 1.80 [46] | 1.89 [48] | 1.00 [25] | 5.54 [141] | .44 [11] | .46 [12] | | PINK | 300 | 2-5/8" | 90°C | |
| YA34A390 | 500 KCMIL | 500 KCMIL | 350 KCMIL DLO (551/22) | 1/2 | 2 | .56 [14] | 4 | 1.32 [34] | 2.34 [59] | 1.62 [41] | 3.15 [80] | 1.75 [44] | 4.09 [104] | .63 [16] | .46 [12] | 4.59 [117] | PINK | 300 | 2-5/8" | 90°C | |
| YA36A1 | 600 KCMIL | 600 KCMIL | 500 KCMIL DLO (779/22) | 5/8 | 1 | .69 [18] | 1 | 1.44 [37] | 2.47 [63] | 1.97 [50] | 1.88 [48] | | 5.82 [148] | .88 [22] | .46 [12] | | BLACK | 473 | 2-7/8" | 90°C | |
| YA36A8 | 600 KCMIL | 600 KCMIL | 500 KCMIL DLO (779/22) | 1/2 | 1 | .56 [14] | 1 | 1.44 [37] | 2.47 [63] | 1.97 [50] | 1.69 [43] | | 5.64 [143] | .69 [18] | .52 [13] | | BLACK | 473 | 2-7/8" | 90°C | |
| YA36A3 | 600 KCMIL | 600 KCMIL | 500 KCMIL DLO (779/22) | 1/2 | 2 | .56 [14] | 2 | 1.44 [37] | 2.47 [63] | 1.62 [41] | 3.15 [80] | 1.75 [44] | 7.09 [180] | .63 [16] | .52 [13] | | BLACK | 473 | 2-7/8" | 90°C | |
| YA36A17 | 600 KCMIL | 600 KCMIL | 500 KCMIL DLO (779/22) | 1/2 | 2 | .56 [14] | 2 | 1.44 [37] | 2.47 [63] | 1.97 [50] | 3.15 [80] | 1.75 [44] | 7.06 [179] | .63 [16] | .52 [13] | | BLACK | 473 | 2-7/8" | 90°C | |
| YA36A5 | 600 KCMIL | 600 KCMIL | 500 KCMIL DLO (779/22) | 3/8 | 2 | .44 [11] | 2 | 1.44 [37] | 2.47 [63] | 1.97 [50] | 1.89 [48] | 1.00 [25] | 5.64 [143] | .69 [18] | .52 [13] | | BLACK | 473 | 2-7/8" | 90°C | |
| YA36A3NT131 | 600 KCMIL | 600 KCMIL | 500 KCMIL DLO (779/22) | 1/2 | 2 | .56 [14] | 2 | 1.44 [37] | 2.47 [63] | 1.31 [33] | 3.15 [80] | 1.75 [44] | 7.09 [180] | .63 [16] | .52 [13] | | BLACK | 473 | 2-7/8" | 90°C | |
| YA39A1 | 750 KCMIL 900 COMPACT | 750 KCMIL | 600 KCMIL DLO (925/22) | 1/2 | 1 | .56 [14] | 1 | 1.46 [37] | 2.46 [62] | 2.05 [52] | 1.34 [34] | | 5.26 [134] | .63 [16] | .43 [11] | | YELLOW | 936 | 2-7/8" | 90°C | |
| YA39A3 | 750 KCMIL 900 COMPACT | 750 KCMIL | 600 KCMIL DLO (925/22) | 5/8 | 1 | .69 [18] | 1 | 1.46 [37] | 2.46 [62] | 2.05 [52] | 1.89 [48] | | 5.80 [147] | .88 [22] | .43 [11] | | YELLOW | 936 | 2-7/8" | 90°C | |
| YA39A34 | 750 KCMIL 900 COMPACT | 750 KCMIL | 600 KCMIL DLO (925/22) | 3/4 | 1 | .81 [21] | 1 | 1.46 [37] | 2.46 [62] | 2.05 [52] | 2.19 [56] | 1.75 [44] | 6.17 [157] | 1.00 [25] | .43 [11] | | YELLOW | 936 | 2-7/8" | 90°C | |
| YA39A5 | 750 KCMIL 900 COMPACT | 750 KCMIL | 600 KCMIL DLO (925/22) | 1/2 | 2 | .56 [14] | 2 | 1.46 [37] | 2.46 [62] | 1.62 [41] | 3.15 [80] | 1.75 [44] | 7.07 [180] | .63 [16] | .43 [11] | | YELLOW | 936 | 2-7/8" | 90°C | |
| YA39A13 | 750 KCMIL 900 COMPACT | 750 KCMIL | 600 KCMIL DLO (925/22) | 1/2 | 2 | .56 [14] | 2 | 1.46 [37] | 2.46 [62] | 2.05 [52] | 3.15 [80] | | 7.04 [179] | .63 [16] | .43 [11] | | YELLOW | 936 | 2-7/8" | 90°C | |

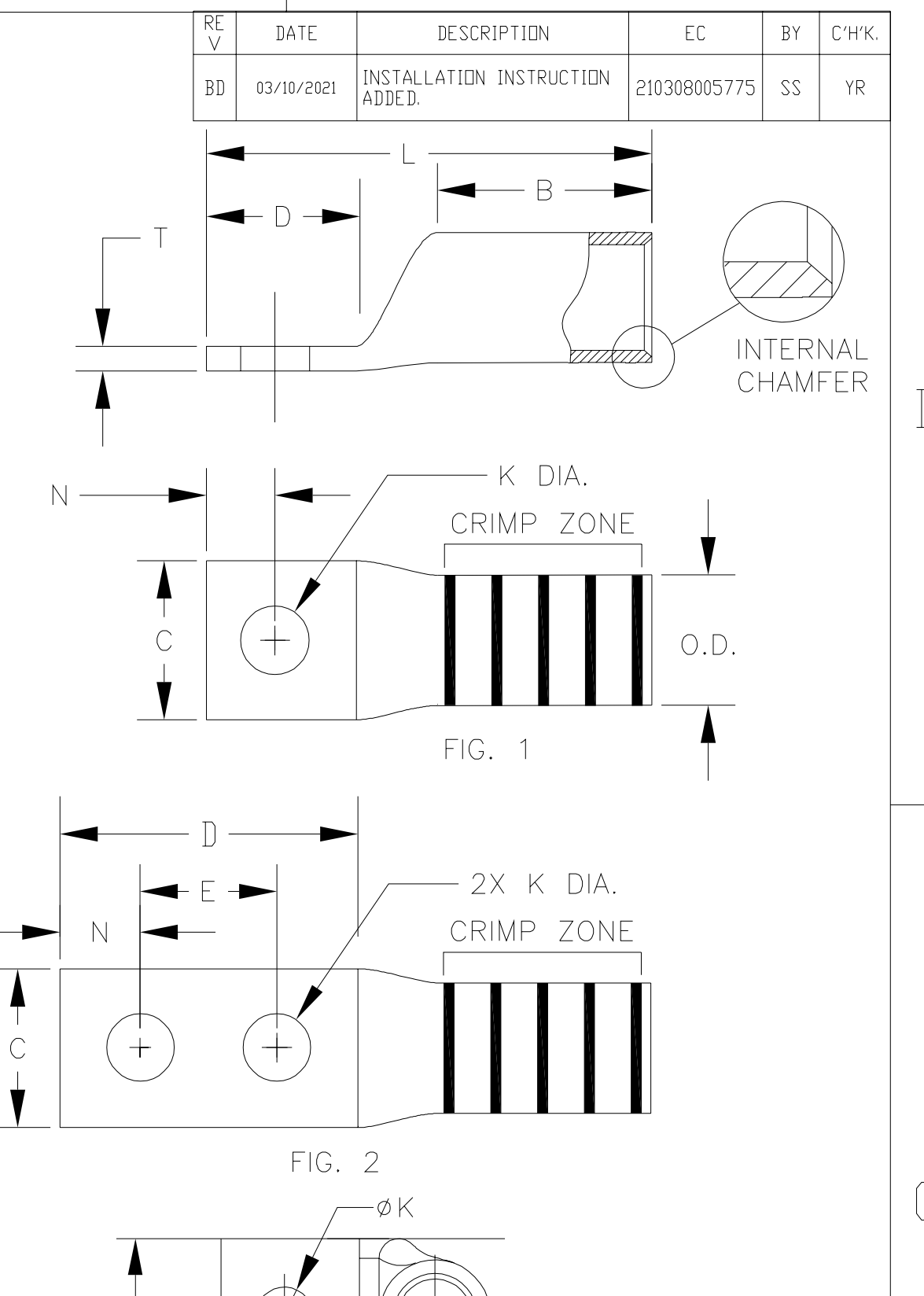

NOTES:

- CONNECTOR: UNINSULATED ALUMINUM COMPRESSION TERMINAL. MADE FROM SEAMLESS ALUMINUM TUBING.
- CONNECTION: COMPRESSION CONNECTIONS MADE ARE IRREVERSIBLE AND MAINTENANCE FREE.
- APPLICABLE STANDARDS: PRODUCTS ARE ONLY UL LISTED AND CSA CERTIFIED WHEN INSTALLED USING THE BURNDY ENGINEERED SYSTEM: TOOLS, DIES (IF APPLICABLE), AND CONNECTORS. THE USE OF OTHER INDUSTRY TOOLING AND OR DIES ON BURNDY CONNECTORS WILL VOID THE UL LISTING AND CSA CERTIFICATIONS.
 - UL LISTING TO UL486A-486B-WIRE CONNECTORS
 - CSA C22.2
- TEMPERATURE AND VOLTAGE RATING:
 - UL LISTED 90°C OR 75°C, UP TO 35kV *SEE CONNECTOR FINISHES FOR ADDITIONAL SERVICE TEMPERATURE RATINGS.
 - ALUMINUM CONNECTORS MARKED AL9CU ACCOMMODATE ALUMINUM (AL) AND COPPER (CU) CODE WIRE UP TO 90°C.
 - ALUMINUM CONNECTORS MARKED AL7CU ACCOMMODATE ALUMINUM (AL) AND COPPER (CU) CODE WIRE UP TO 75°C.
- WIRE ACCOMMODATE TYPES (SEE TABLE): DUAL RATED TO ACCOMMODATE ALUMINUM AND COPPER WIRE.
 - CODE ALUMINUM WIRE (CU): CLASS B (CONCENTRIC, COMPRESS, COMPACT) STRANDING.
 - CODE COPPER WIRE (AL): CLASS B (CONCENTRIC, COMPRESS, COMPACT) OR CLASS C STRANDING.
 - COPPER CLAD ALUMINUM (CCA) STRANDING: SEE TABLE FOR SELECT TERMINALS AND APPLICABLE CCA WIRE SIZES.
- CONNECTOR FINISHES AND SUFFIX: SEE SECTION C OF THE BURNDY MASTER CATALOG FOR PLATING SERVICE TEMPERATURE RATINGS.
 - ELECTRO-TIN PLATED: CONNECTORS HAVING NO SUFFIX ARE TIN PLATED UNLESS OTHERWISE SPECIFIES. CATALOG NUMBER EXAMPLE: YA34A3.
 - NICKEL PLATED: APPLY SUFFIX "NK" TO A CATALOG NUMBER IN THE TABLE, IF NOT SPECIFIED. CATALOG NUMBER EXAMPLE: YA34A3NK.
 - SILVER PLATED: APPLY SUFFIX "SV" TO A CATALOG NUMBER IN THE TABLE, IF NOT SPECIFIED. CATALOG NUMBER EXAMPLE: YA34A3SV.
 - TIN ZINC : APPLY SUFFIX "TZ" TO A CATALOG NUMBER IN THE TABLE, IF NOT SPECIFIED. CATALOG NUMBER EXAMPLE: YA34A3TZ.
 - BARE CONNECTORS: APPLYING SUFFIX "BR" TO A CATALOG NUMBER IN THE TABLE, IF NOT SPECIFIED. CATALOG NUMBER EXAMPLE: YA343BR.
- FEATURES:
 - BARREL TYPICAL ROLL MARKINGS (AS SPACE PERMITS): CRIMP ZONE IS INDICATED BY KNURL BANDS, BURNDY CORPORATE NAME OR LOGO, UL LOGO (IF APPLICABLE), CSA LOGO (IF APPLICABLE), WIRE SIZE, DIE COLOR CODE (IF SPACE PERMITS), DIE INDEX NUMBER.
 - BARREL DESIGN: BARREL END AT THE WIRE HAS AN INTERNAL CHAMFER, ALLOWING FOR A SMOOTH WIRE INSERTION.
 - TERMINALS ARE PRE-FILLED WITH PENETROX™ A13, WHICH IS AN OXIDE INHIBITOR.
 - EACH TERMINAL HAS A COLOR-CODED END CAP TO MATCH THE DIE COLOR CODE. THIS ALSO PREVENTS PARTICLES FROM ENTERING THE BARREL.
 - PAD/TONGUE/TANG/SPADE DESIGN: ONE-HOLE, TWO-HOLE, AND FOUR HOLE DESIGNS. CONTACT CUSTOMER SERVICE FOR ALTERNATE PAD CONFIGURATIONS.
 - FIELD BENDING STRAIGHT LUGS TO ACHIEVE AN ANGULAR CONNECTION WILL VOID ALL APPLICABLE STANDARDS LISTED IN NOTE 2.
 - CATALOG NUMBER SUFFIX DT OR DTS: INDICATES THAT THE TRANSITION IN THE TERMINAL BETWEEN THE PAD AND BARREL ARE SOLDER OR BRAZE SEALED TO BE OIL TIGHT INSIDE THE BARREL. THIS PREVENTS ANY LIQUIDS FROM EXITING OR ENTERING THE BARREL THROUGH THE PAD.
 - IF NOT LISTED IN THE TABLE, PLEASE CONTACT CUSTOMER SERVICE FOR 45°, 90°, AND OR OTHER ANGULAR LUGS FOR PRODUCT AVAILABILITY. CATALOG NUMBER SUFFIX 45 INDICATES THAT THE TERMINAL IS BENT AT A 45 DEGREE ANGLE. CATALOG NUMBER SUFFIX 90 INDICATES THAT THE TERMINAL IS BENT AT A 90 DEGREE ANGLE.
- INSTALLATION TOOLING AND DIES ARE CONSTANTLY BEING UPDATED. PLEASE SEE BURNDY MASTER CATALOG FOR THIS PRODUCT FAMILY, WHICH CAN BE FOUND ON THE BURNDY WEBSITE.
- SPECIAL REQUIREMENTS:
 - YA39A- CONNECTORS: 900 KCMIL CLASS B COMPACT WIRE REQUIRES THE USE OF THE 644 SERIES OR 444 SERIES DIE-LESS INSTALLATION TOOLS AND 2 CRIMPS.
 - YA42A- CONNECTORS: 600 KCMIL CU REQUIRES THE USE OF THE 644 SERIES OR 444 SERIES DIE-LESS INSTALLATION TOOLS.
 - YA44A- CONNECTORS ACCOMMODATE 1100 KCMIL WIRE CLASS A AND CLASS B COMPACT, BUT IS NOT UL LISTED OR CSA CERTIFIED.
- DIMENSIONS IN BRACKETS [] ARE IN MILLIMETERS ROUNDED OFF TO THE NEAREST MILLIMETER, UNLESS OTHERWISE SPECIFIED AND ARE FOR REFERENCE ONLY.
- CATALOG NUMBER SCHEME: EX: YA34A3.
 - Y = COMPRESSION, A = TERMINAL, 34 = WIRE SIZE (500 KCMIL), A = ALUMINUM CONNECTOR, 3 = HOLE SIZE AND PATTERN.

TYPICAL MARKINGS:

- BURNDY COMPANY IDENTIFIER
- UL LOGO, IF APPLICABLE
- CSA LOGO, IF APPLICABLE
- BURNDY CATALOG NUMBER
- WIRE ACCOMMODATES
- COLOR CODE IDENTIFIER
- DIE INDEX NUMBER
- CRIMP ZONE BANDS (KNURL MARKS)

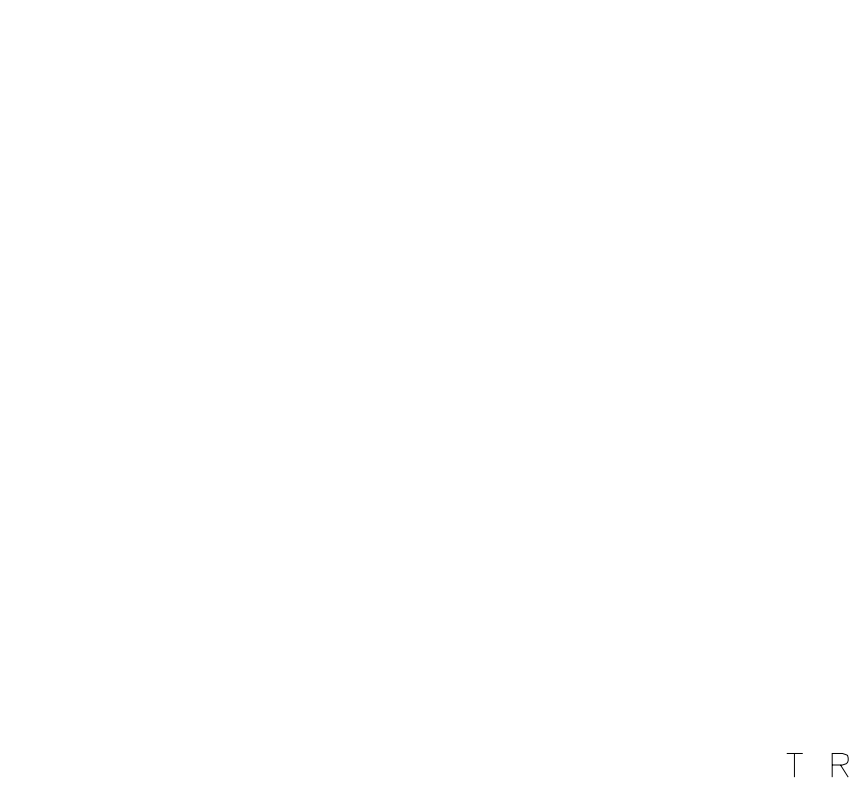
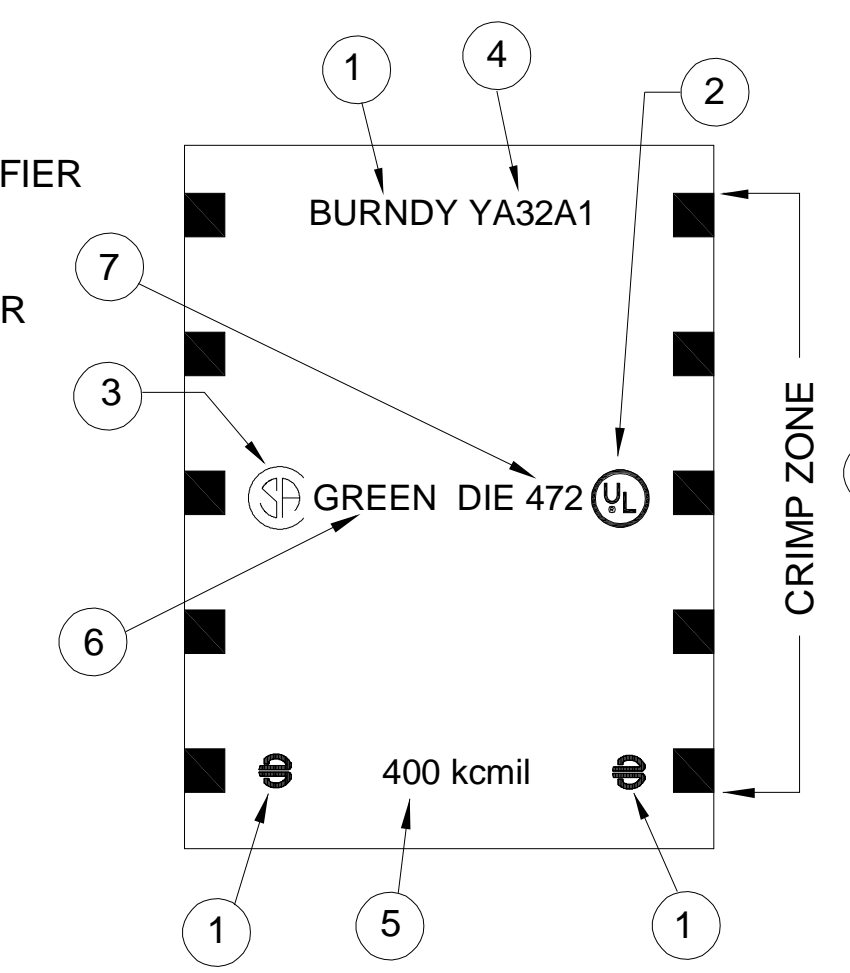

TO ORDER BURNDY® PRODUCTS CALL
 UNITED STATES
 1-800-346-4175 (LONDONDERRY, NH)
 CANADA:
 1-800-361-6975 (QUEBEC)
 1-800-387-6487 (ALL OTHER PROVINCES)
 FOR PRODUCT INFO: <http://www.burndy.com>

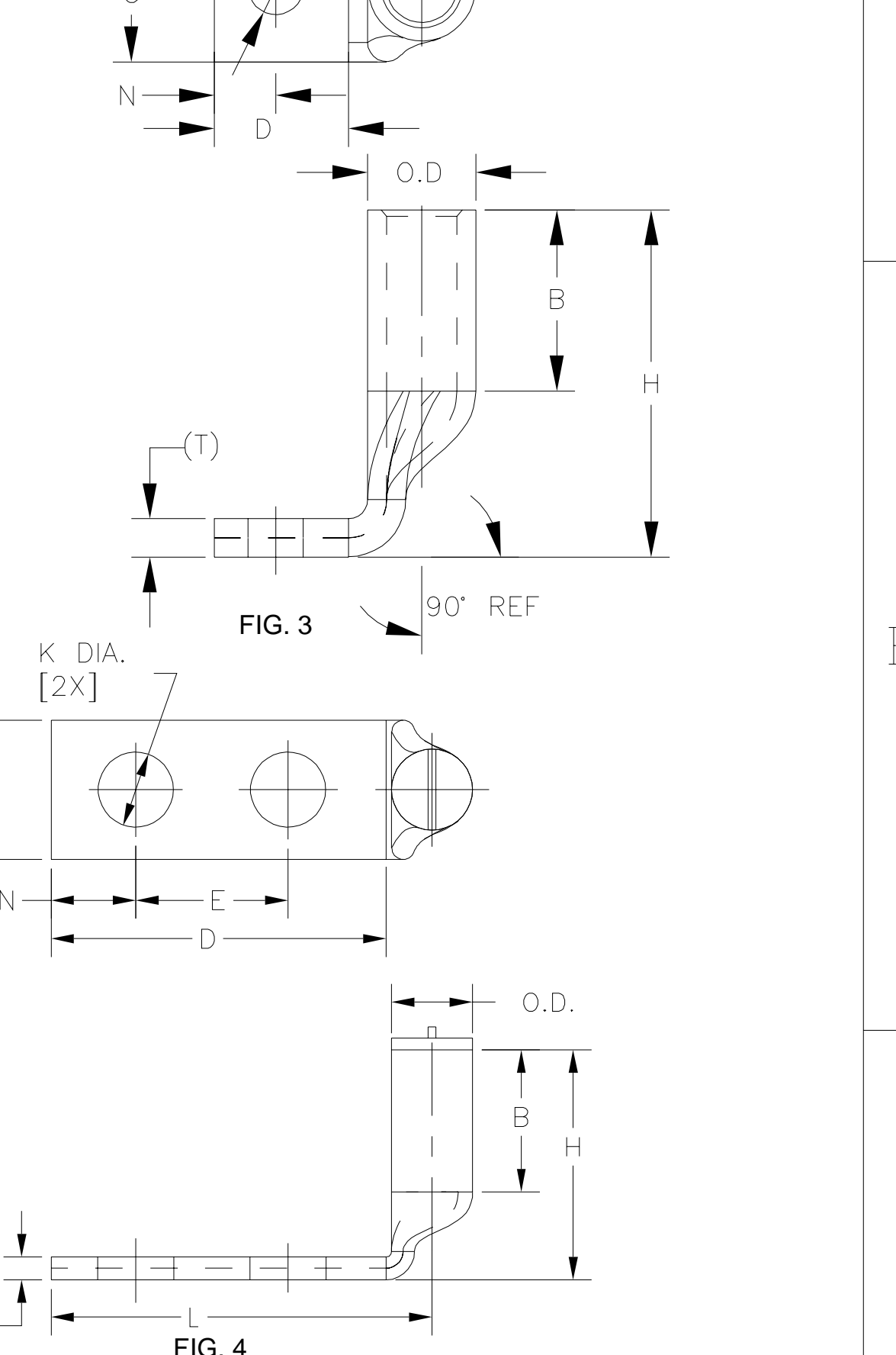

| HYLUG™ | | SCALE | NTS |
|----------------|---------------------|---------------|-----|
| ITEM NO: | N/A | | |
| CAT. NO: | YABCA - (SEE TABLE) | | |
| DRAWN BY: | E.S.K. 7/19/72 | | |
| CHECKER: | S.F.P. 8/01/72 | | |
| DSN APPVL: | R.B. 8/02/72 | | |
| MFG APPVL: | -- | | |
| QA APPVL: | D. VARID 6/19/95 | | |
| MKT APPVL: | -- | | |
| PRDD FAM: | CM&R COMPRESSION | DRAWING NO | REV |
| PROJECT #: | -- | SD.073935 | BD |
| DOCUMENT TYPE: | Sales | | |
| REL LEVEL: | Released | SHEET 3 OF 10 | |

| 6 11 CATALOG NUMBER | 5 WIRE / CONDUCTOR SIZE | | | STUD SIZE | NO. OF HOLES | STUD HOLE DIAMETER (K) | FIG. | OUTSIDE DIAMETER (OD) | BARREL LENGTH (B) | PAD WIDTH (C) | PAD LENGTH (D) | HOLE SPACING (E >> F) | OVERALL LENGTH (L) | HOLE OFFSET (N) | PAD THICKNESS (T) | HEIGHT (H) | COLOR CODE | DIE INDEX | WIRE STRIP LENGTH | 4 TEMP RATING |
|---------------------------|----------------------------|-----------|------------------------|-----------|--------------|------------------------|------|-----------------------|-------------------|---------------|----------------|-----------------------|--------------------|-----------------|-------------------|------------|------------|-----------|-------------------|------------------|
| | ALUMINUM | COPPER | CCA | | | | | | | | | | | | | | | | | |
| YA39AM2 | 750 KCMIL 900 COMPACT | 750 KCMIL | 600 KCMIL DLO (925/22) | 1/2 | 2 | .56 [14] | 2 | 1.60 [41] | 2.56 [65] | 1.69 [43] | 3.12 [79] | 1.75 [44] | 7.31 [186] | .63 [16] | .57 [14] | | RED | 301.00 | 2-7/8" | 90°C |
| YA39AM3 | 750 KCMIL 900 COMPACT | 750 KCMIL | 600 KCMIL DLO (925/22) | 1/2 | 2 | .56 [14] | 2 | 1.60 [41] | 2.56 [65] | 1.69 [43] | 3.88 [99] | 1.75 [44] | 8.07 [205] | .63 [16] | .57 [14] | | RED | 301.00 | 2-7/8" | 90°C |
| YA40A1 | 800 KCMIL | 800 KCMIL | | 5/8 | 1 | .69 [18] | 1 | 1.65 [42] | 2.56 [65] | 1.65 [42] | 1.87 [47] | | 6.12 [155] | .88 [22] | .60 [15] | | GRAY | 474.00 | 3" | 90°C |
| YA40A3 | 800 KCMIL | 800 KCMIL | | 1/2 | 2 | .56 [14] | 2 | 1.65 [42] | 2.56 [65] | 2.25 [57] | 3.16 [80] | 1.75 [44] | 7.41 [188] | .63 [16] | .60 [15] | | GRAY | 474.00 | 3" | 90°C |

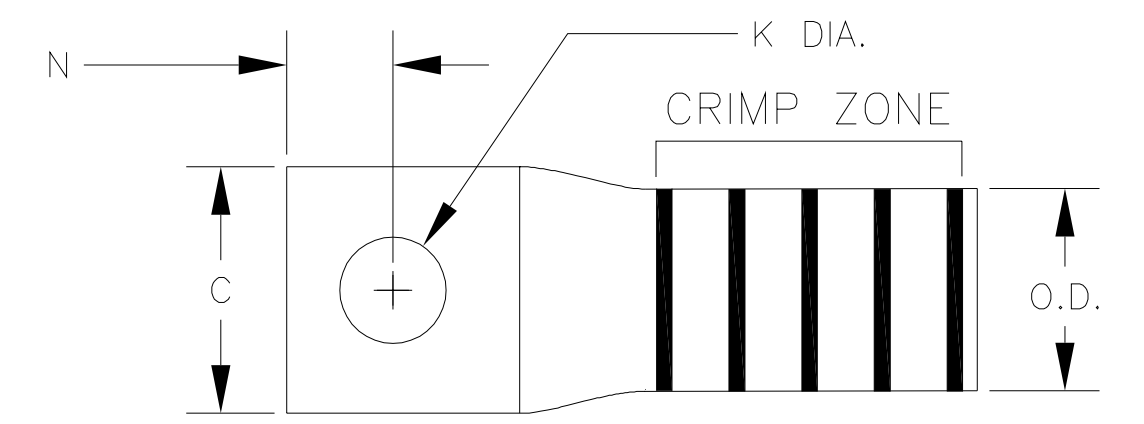
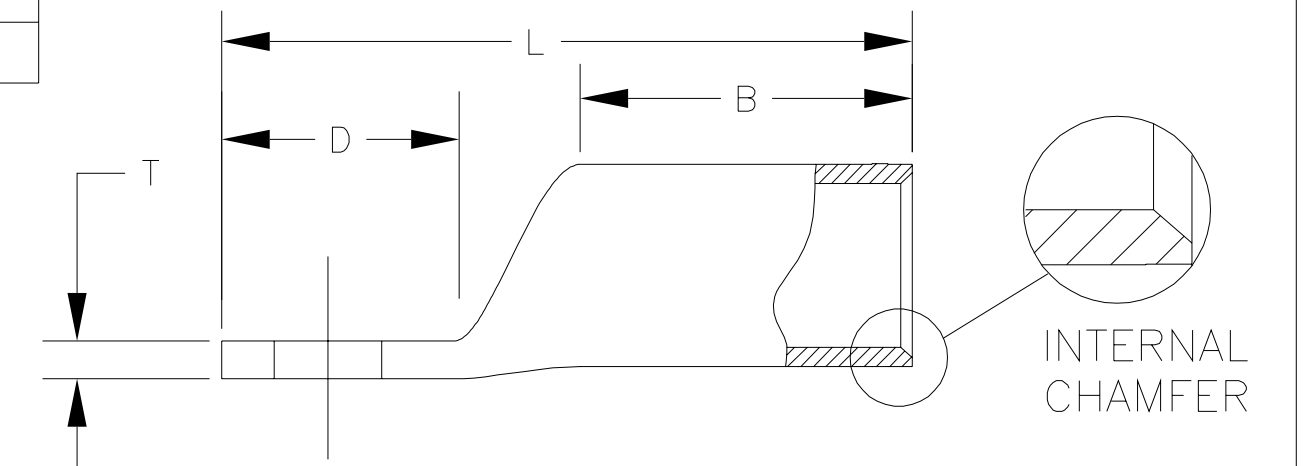

FIG. 1

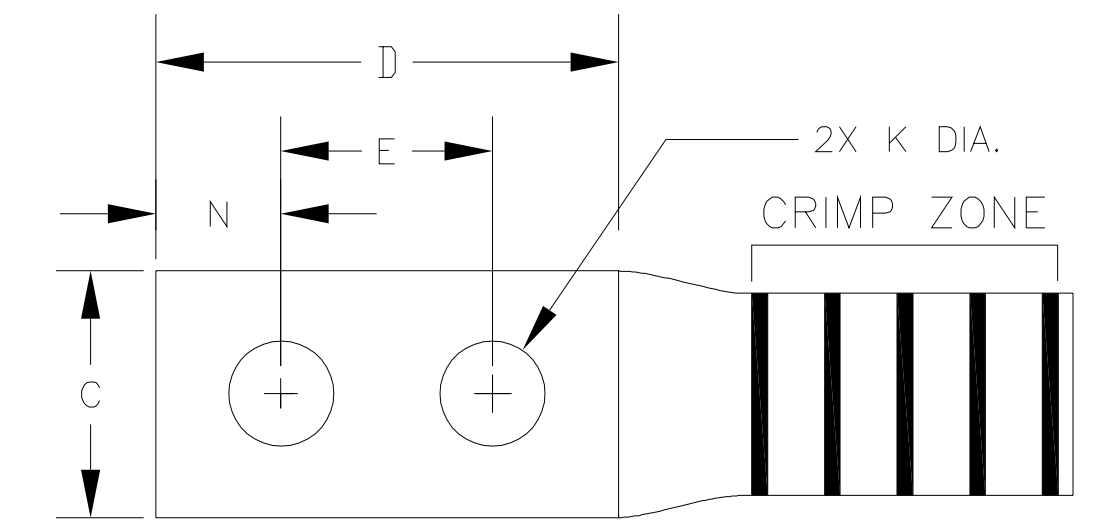

FIG. 2

NOTES:

- CONNECTOR: UNINSULATED ALUMINUM COMPRESSION TERMINAL. MADE FROM SEAMLESS ALUMINUM TUBING.
- CONNECTION: COMPRESSION CONNECTIONS MADE ARE IRREVERSIBLE AND MAINTENANCE FREE.
- APPLICABLE STANDARDS: PRODUCTS ARE ONLY UL LISTED AND CSA CERTIFIED WHEN INSTALLED USING THE BURNDY ENGINEERED SYSTEM: TOOLS, DIES (IF APPLICABLE), AND CONNECTORS. THE USE OF OTHER INDUSTRY TOOLING AND OR DIES ON BURNDY CONNECTORS WILL VOID THE UL LISTING AND CSA CERTIFICATIONS.
 - UL LISTING TO UL486A-486B-WIRE CONNECTORS
 - CSA C22.2
- TEMPERATURE AND VOLTAGE RATING:
 - UL LISTED 90°C OR 75°C, UP TO 35kV *SEE CONNECTOR FINISHES FOR ADDITIONAL SERVICE TEMPERATURE RATINGS.
 - ALUMINUM CONNECTORS MARKED AL9CU ACCOMMODATE ALUMINUM (AL) AND COPPER (CU) CODE WIRE UP TO 90°C.
 - ALUMINUM CONNECTORS MARKED AL7CU ACCOMMODATE ALUMINUM (AL) AND COPPER (CU) CODE WIRE UP TO 75°C.
- WIRE ACCOMMODATE TYPES (SEE TABLE): DUAL RATED TO ACCOMMODATE ALUMINUM AND COPPER WIRE.
 - CODE ALUMINUM WIRE (CU): CLASS B (CONCENTRIC, COMPRESS, COMPACT) STRANDING.
 - CODE COPPER WIRE (AL): CLASS B (CONCENTRIC, COMPRESS, COMPACT) OR CLASS C STRANDING.
 - COPPER CLAD ALUMINUM (CCA) STRANDING: SEE TABLE FOR SELECT TERMINALS AND APPLICABLE CCA WIRE SIZES.
- CONNECTOR FINISHES AND SUFFIX: SEE SECTION C OF THE BURNDY MASTER CATALOG FOR PLATING SERVICE TEMPERATURE RATINGS.
 - ELECTRO-TIN PLATED: CONNECTORS HAVING NO SUFFIX ARE TIN PLATED UNLESS OTHERWISE SPECIFIES. CATALOG NUMBER EXAMPLE: YA34A3.
 - NICKEL PLATED: APPLY SUFFIX "NK" TO A CATALOG NUMBER IN THE TABLE, IF NOT SPECIFIED. CATALOG NUMBER EXAMPLE: YA34A3NK.
 - SILVER PLATED: APPLY SUFFIX "SV" TO A CATALOG NUMBER IN THE TABLE, IF NOT SPECIFIED. CATALOG NUMBER EXAMPLE: YA34A3SV.
 - TIN ZINC : APPLY SUFFIX "TZ" TO A CATALOG NUMBER IN THE TABLE, IF NOT SPECIFIED. CATALOG NUMBER EXAMPLE: YA34A3TZ.
 - BARE CONNECTORS: APPLYING SUFFIX "BR" TO A CATALOG NUMBER IN THE TABLE, IF NOT SPECIFIED. CATALOG NUMBER EXAMPLE: YA343BR.
- FEATURES:
 - BARREL TYPICAL ROLL MARKINGS (AS SPACE PERMITS): CRIMP ZONE IS INDICATED BY KNURL BANDS, BURNDY CORPORATE NAME OR LOGO, UL LOGO (IF APPLICABLE), CSA LOGO (IF APPLICABLE), WIRE SIZE, DIE COLOR CODE (IF SPACE PERMITS), DIE INDEX NUMBER.
 - BARREL DESIGN: BARREL END AT THE WIRE HAS AN INTERNAL CHAMFER, ALLOWING FOR A SMOOTH WIRE INSERTION.
 - TERMINALS ARE PRE-FILLED WITH PENETROX™ A13, WHICH IS AN OXIDE INHIBITOR.
 - EACH TERMINAL HAS A COLOR-CODED END CAP TO MATCH THE DIE COLOR CODE. THIS ALSO PREVENTS PARTICLES FROM ENTERING THE BARREL.
 - PAD/TONGUE/TANG/SPADE DESIGN: ONE-HOLE, TWO-HOLE, AND FOUR HOLE DESIGNS. CONTACT CUSTOMER SERVICE FOR ALTERNATE PAD CONFIGURATIONS.
 - FIELD BENDING STRAIGHT LUGS TO ACHIEVE AN ANGULAR CONNECTION WILL VOID ALL APPLICABLE STANDARDS LISTED IN NOTE 2.
 - CATALOG NUMBER SUFFIX DT OR DTS: INDICATES THAT THE TRANSITION IN THE TERMINAL BETWEEN THE PAD AND BARREL ARE SOLDER OR BRAZE SEALED TO BE OIL TIGHT INSIDE THE BARREL. THIS PREVENTS ANY LIQUIDS FROM EXITING OR ENTERING THE BARREL THROUGH THE PAD.
 - IF NOT LISTED IN THE TABLE, PLEASE CONTACT CUSTOMER SERVICE FOR 45°, 90°, AND OR OTHER ANGULAR LUGS FOR PRODUCT AVAILABILITY. CATALOG NUMBER SUFFIX 45 INDICATES THAT THE TERMINAL IS BENT AT A 45 DEGREE ANGLE. CATALOG NUMBER SUFFIX 90 INDICATES THAT THE TERMINAL IS BENT AT A 90 DEGREE ANGLE.
- INSTALLATION TOOLING AND DIES ARE CONSTANTLY BEING UPDATED. PLEASE SEE BURNDY MASTER CATALOG FOR THIS PRODUCT FAMILY, WHICH CAN BE FOUND ON THE BURNDY WEBSITE.
- SPECIAL REQUIREMENTS:
 - YA39A- CONNECTORS: 900 KCMIL CLASS B COMPACT WIRE REQUIRES THE USE OF THE 644 SERIES OR 444 SERIES DIE-LESS INSTALLATION TOOLS AND 2 CRIMPS.
 - YA42A- CONNECTORS: 600 KCMIL CU REQUIRES THE USE OF THE 644 SERIES OR 444 SERIES DIE-LESS INSTALLATION TOOLS.
 - YA44A- CONNECTORS ACCOMMODATE 1100 KCMIL WIRE CLASS A AND CLASS B COMPACT, BUT IS NOT UL LISTED OR CSA CERTIFIED.
- DIMENSIONS IN BRACKETS [] ARE IN MILLIMETERS ROUNDED OFF TO THE NEAREST MILLIMETER, UNLESS OTHERWISE SPECIFIED AND ARE FOR REFERENCE ONLY.
- CATALOG NUMBER SCHEME: EX: YA34A3.
 - Y = COMPRESSION, A = TERMINAL, 34 = WIRE SIZE (500 KCMIL), A = ALUMINUM CONNECTOR, 3 = HOLE SIZE AND PATTERN.

TYPICAL MARKINGS:

- BURNDY COMPANY IDENTIFIER
- UL LOGO, IF APPLICABLE
- CSA LOGO, IF APPLICABLE
- BURNDY CATALOG NUMBER
- WIRE ACCOMMODATES
- COLOR CODE IDENTIFIER
- DIE INDEX NUMBER
- CRIMP ZONE BANDS (KNURL MARKS)

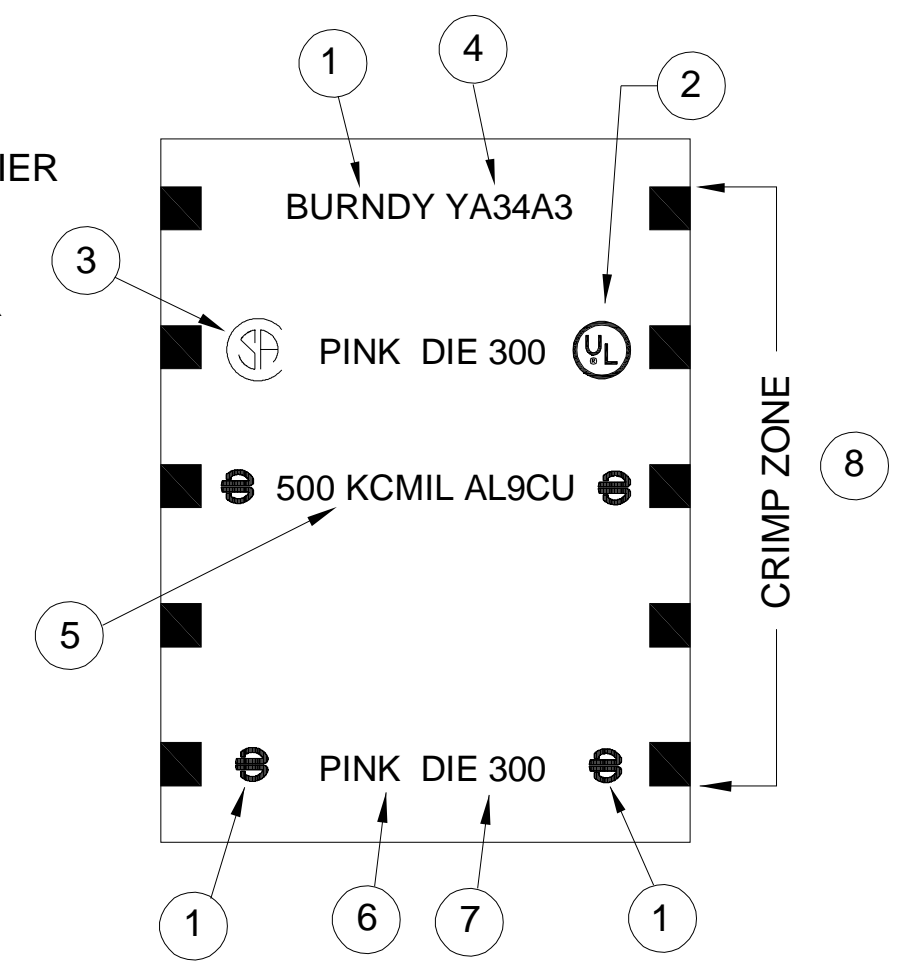

| | | | |
|-----------------------------------------------------------------------------|--|----------------------------|------------------------------|
| TO ORDER BURNDY® PRODUCTS CALL | | HYLUG™ | |
| UNITED STATES 1-800-346-4175 (LONDONDERRY, NH) | | ITEM NO: N/A | CAT. NO: YABCA - (SEE TABLE) |
| CANADA: 1-800-361-6975 (QUEBEC) 1-800-387-6487 (ALL OTHER PROVINCES) | | DRAWN BY: E.S.K. 7/19/72 | CHECKER: S.F.P. 8/01/72 |
| FOR PRODUCT INFO: http://www.burndy.com | | DSN APPVL: R.B. 8/02/72 | MFG APPVL: -- -- |
| | | QA APPVL: D. VARID 6/19/95 | MKT APPVL: -- -- |
| | | PRD. FAM: CM&R COMPRESSION | DRAWING NO: SD.073935 |
| | | PROJECT #: -- | SIZE: D |
| | | DOCUMENT TYPE: Sales | SHEET 4 OF 10 |
| | | REL. LEVEL: Released | SCALE: NTS |
| | | | REV: BD |

REV: PE0200

| 6 | 11 | 5 WIRE / CONDUCTOR SIZE | | | STUD SIZE | NO. OF HOLES | STUD HOLE DIAMETER (K) | FIG. | OUTSIDE DIAMETER (OD) | BARREL LENGTH (B) | PAD WIDTH (C) | PAD LENGTH (D) | HOLE SPACING (E >> F) | OVERALL LENGTH (L) | HOLE OFFSET (N) | PAD THICKNESS (T) | HEIGHT (H) | COLOR CODE | DIE INDEX | WIRE STRIP LENGTH | 4 TEMP RATING |
|--------|----|-------------------------|-----------|-----|-----------|--------------|------------------------|------|-----------------------|-------------------|---------------|----------------|-----------------------|--------------------|-----------------|-------------------|------------|------------|-----------|-------------------|---------------|
| | | ALUMINUM | COPPER | CCA | | | | | | | | | | | | | | | | | |
| YA42A1 | | 900 KCMIL | 600 KCMIL | | 1/2 | 1 | .56 [14] | 1 | 1.50 [38] | 2.46 [62] | 2.14 [54] | 1.36 [35] | | 5.32 [135] | .63 [16] | .39 [10] | | GRAY | 303 | 2-7/8" | 90°C |
| YA42A3 | | 900 KCMIL | 600 KCMIL | | 5/8 | 1 | .69 [18] | 1 | 1.50 [38] | 2.46 [62] | 2.14 [54] | 1.86 [47] | | 5.82 [148] | .88 [22] | .39 [10] | | GRAY | 303 | 2-7/8" | 90°C |
| YA42A5 | | 900 KCMIL | 600 KCMIL | | 1/2 | 2 | .56 [14] | 2 | 1.50 [38] | 2.46 [62] | 1.62 [41] | 3.13 [79] | 1.75 [44] | 7.09 [180] | .63 [16] | .39 [10] | | GRAY | 303 | 2-7/8" | 90°C |
| YA42A7 | | 900 KCMIL | 600 KCMIL | | 3/8 | 2 | .44 [11] | 2 | 1.50 [38] | 2.46 [62] | 2.14 [54] | 2.00 [51] | 1.00 [25] | 5.96 [151] | .44 [11] | .39 [10] | | GRAY | 303 | 2-7/8" | 90°C |

| REV | DATE | DESCRIPTION | EC | BY | CHK. |
|-----|------------|--------------------------------|--------------|----|------|
| BD | 03/10/2021 | INSTALLATION INSTRUCTION ADDED | 210308005775 | SS | YR |

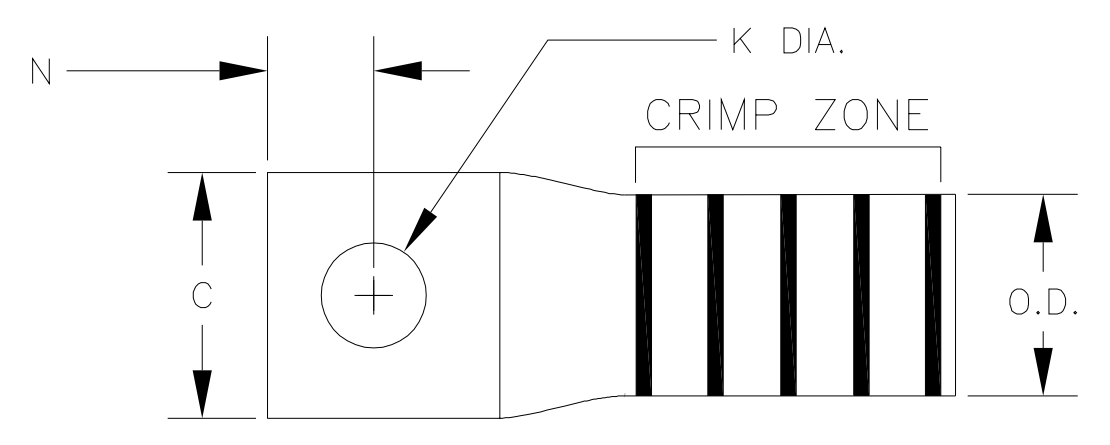
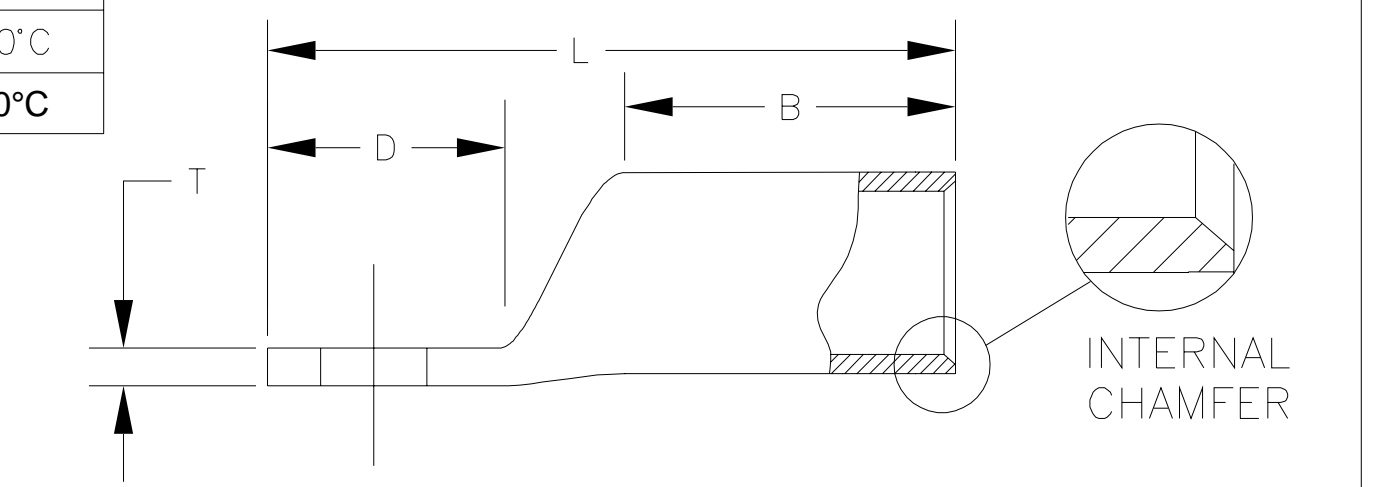

FIG. 1

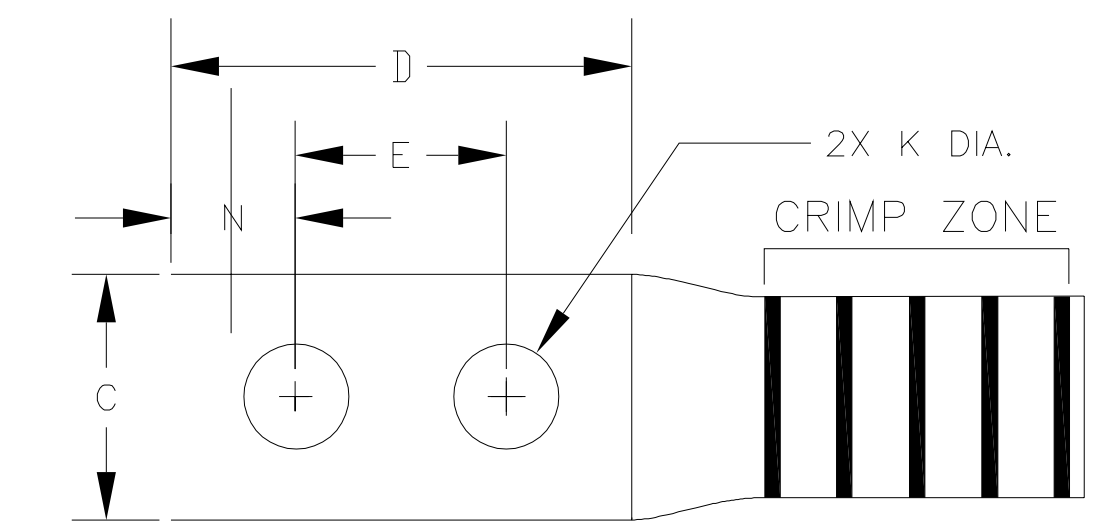

FIG. 2

NOTES:

- CONNECTOR: UNINSULATED ALUMINUM COMPRESSION TERMINAL. MADE FROM SEAMLESS ALUMINUM TUBING.
- CONNECTION: COMPRESSION CONNECTIONS MADE ARE IRREVERSIBLE AND MAINTENANCE FREE.
- APPLICABLE STANDARDS: PRODUCTS ARE ONLY UL LISTED AND CSA CERTIFIED WHEN INSTALLED USING THE BURNDY ENGINEERED SYSTEM: TOOLS, DIES (IF APPLICABLE), AND CONNECTORS. THE USE OF OTHER INDUSTRY TOOLING AND OR DIES ON BURNDY CONNECTORS WILL VOID THE UL LISTING AND CSA CERTIFICATIONS.
 - UL LISTING TO UL486A-486B-WIRE CONNECTORS
 - CSA C22.2
- TEMPERATURE AND VOLTAGE RATING:
 - UL LISTED 90°C OR 75°C, UP TO 35kV *SEE CONNECTOR FINISHES FOR ADDITIONAL SERVICE TEMPERATURE RATINGS.
 - ALUMINUM CONNECTORS MARKED AL9CU ACCOMMODATE ALUMINUM (AL) AND COPPER (CU) CODE WIRE UP TO 90°C.
 - ALUMINUM CONNECTORS MARKED AL7CU ACCOMMODATE ALUMINUM (AL) AND COPPER (CU) CODE WIRE UP TO 75°C.
- WIRE ACCOMMODATE TYPES (SEE TABLE): DUAL RATED TO ACCOMMODATE ALUMINUM AND COPPER WIRE.
 - CODE ALUMINUM WIRE (CU): CLASS B (CONCENTRIC, COMPRESS, COMPACT) STRANDING.
 - CODE COPPER WIRE (AL): CLASS B (CONCENTRIC, COMPRESS, COMPACT) OR CLASS C STRANDING.
 - COPPER CLAD ALUMINUM (CCA) STRANDING: SEE TABLE FOR SELECT TERMINALS AND APPLICABLE CCA WIRE SIZES.
- CONNECTOR FINISHES AND SUFFIX: SEE SECTION C OF THE BURNDY MASTER CATALOG FOR PLATING SERVICE TEMPERATURE RATINGS.
 - ELECTRO-TIN PLATED: CONNECTORS HAVING NO SUFFIX ARE TIN PLATED UNLESS OTHERWISE SPECIFIES. CATALOG NUMBER EXAMPLE: YA34A3.
 - NICKEL PLATED: APPLY SUFFIX "NK" TO A CATALOG NUMBER IN THE TABLE, IF NOT SPECIFIED. CATALOG NUMBER EXAMPLE: YA34A3NK.
 - SILVER PLATED: APPLY SUFFIX "SV" TO A CATALOG NUMBER IN THE TABLE, IF NOT SPECIFIED. CATALOG NUMBER EXAMPLE: YA34A3SV.
 - TIN ZINC : APPLY SUFFIX "TZ" TO A CATALOG NUMBER IN THE TABLE, IF NOT SPECIFIED. CATALOG NUMBER EXAMPLE: YA34A3TZ.
 - BARE CONNECTORS: APPLYING SUFFIX "BR" TO A CATALOG NUMBER IN THE TABLE, IF NOT SPECIFIED. CATALOG NUMBER EXAMPLE: YA343BR.
- FEATURES:
 - BARREL TYPICAL ROLL MARKINGS (AS SPACE PERMITS): CRIMP ZONE IS INDICATED BY KNURL BANDS, BURNDY CORPORATE NAME OR LOGO, UL LOGO (IF APPLICABLE), CSA LOGO (IF APPLICABLE), WIRE SIZE, DIE COLOR CODE (IF SPACE PERMITS), DIE INDEX NUMBER.
 - BARREL DESIGN: BARREL END AT THE WIRE HAS AN INTERNAL CHAMFER, ALLOWING FOR A SMOOTH WIRE INSERTION.
 - TERMINALS ARE PRE-FILLED WITH PENETROX™ A13, WHICH IS AN OXIDE INHIBITOR.
 - EACH TERMINAL HAS A COLOR-CODED END CAP TO MATCH THE DIE COLOR CODE. THIS ALSO PREVENTS PARTICLES FROM ENTERING THE BARREL.
 - PAD/TONGUE/TANG/SPADE DESIGN: ONE-HOLE, TWO-HOLE, AND FOUR HOLE DESIGNS. CONTACT CUSTOMER SERVICE FOR ALTERNATE PAD CONFIGURATIONS.
 - FIELD BENDING STRAIGHT LUGS TO ACHIEVE AN ANGULAR CONNECTION WILL VOID ALL APPLICABLE STANDARDS LISTED IN NOTE 2.
 - CATALOG NUMBER SUFFIX DT OR DTS: INDICATES THAT THE TRANSITION IN THE TERMINAL BETWEEN THE PAD AND BARREL ARE SOLDER OR BRAZE SEALED TO BE OIL TIGHT INSIDE THE BARREL. THIS PREVENTS ANY LIQUIDS FROM EXITING OR ENTERING THE BARREL THROUGH THE PAD.
 - IF NOT LISTED IN THE TABLE, PLEASE CONTACT CUSTOMER SERVICE FOR 45°, 90°, AND OR OTHER ANGULAR LUGS FOR PRODUCT AVAILABILITY. CATALOG NUMBER SUFFIX 45 INDICATES THAT THE TERMINAL IS BENT AT A 45 DEGREE ANGLE. CATALOG NUMBER SUFFIX 90 INDICATES THAT THE TERMINAL IS BENT AT A 90 DEGREE ANGLE.
- INSTALLATION TOOLING AND DIES ARE CONSTANTLY BEING UPDATED. PLEASE SEE BURNDY MASTER CATALOG FOR THIS PRODUCT FAMILY, WHICH CAN BE FOUND ON THE BURNDY WEBSITE.
- SPECIAL REQUIREMENTS:
 - YA39A- CONNECTORS: 900 KCMIL CLASS B COMPACT WIRE REQUIRES THE USE OF THE 644 SERIES OR 444 SERIES DIE-LESS INSTALLATION TOOLS AND 2 CRIMPS.
 - YA42A- CONNECTORS: 600 KCMIL CU REQUIRES THE USE OF THE 644 SERIES OR 444 SERIES DIE-LESS INSTALLATION TOOLS.
 - YA44A- CONNECTORS ACCOMMODATE 1100 KCMIL WIRE CLASS A AND CLASS B COMPACT, BUT IS NOT UL LISTED OR CSA CERTIFIED.
- DIMENSIONS IN BRACKETS [] ARE IN MILLIMETERS ROUNDED OFF TO THE NEAREST MILLIMETER, UNLESS OTHERWISE SPECIFIED AND ARE FOR REFERENCE ONLY.
- CATALOG NUMBER SCHEME: EX: YA34A3.
 - Y = COMPRESSION, A = TERMINAL, 34 = WIRE SIZE (500 KCMIL), A = ALUMINUM CONNECTOR, 3 = HOLE SIZE AND PATTERN.

TYPICAL MARKINGS:

- BURNDY COMPANY IDENTIFIER
- UL LOGO, IF APPLICABLE
- CSA LOGO, IF APPLICABLE
- BURNDY CATALOG NUMBER
- WIRE ACCOMMODATES
- COLOR CODE IDENTIFIER
- DIE INDEX NUMBER
- CRIMP ZONE BANDS (KNURL MARKS)

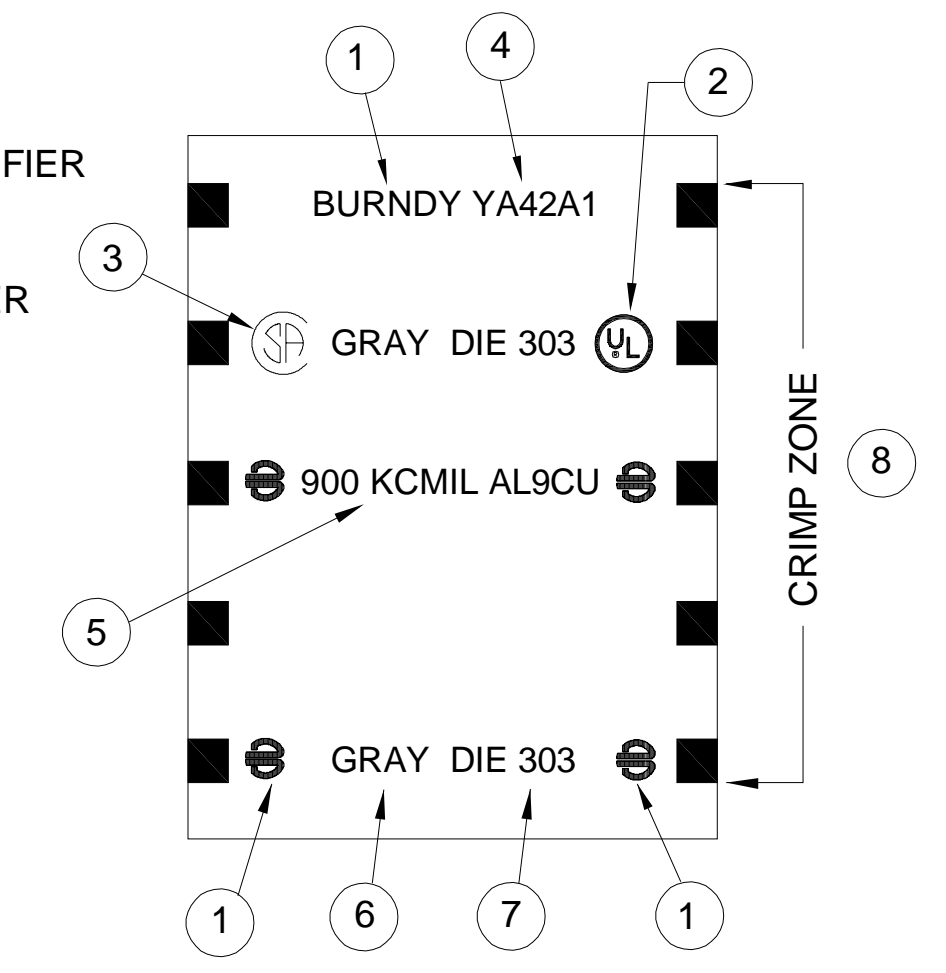

| TO ORDER BURNDY® PRODUCTS CALL | | HYLUG™ | |
|-----------------------------------------------------------------------------|--|----------------|---------------------|
| UNITED STATES 1-800-346-4175 (LONDONDERRY, NH) | | ITEM NO: | N/A |
| CANADA: 1-800-361-6975 (QUEBEC) 1-800-387-6487 (ALL OTHER PROVINCES) | | CAT. NO: | YABCA - (SEE TABLE) |
| FOR PRODUCT INFO: http://www.burndy.com | | DRAWN BY: | E.S.K. 7/19/72 |
| | | CHECKER: | S.F.P. 8/01/72 |
| | | DSN APPVL: | R.B. 8/02/72 |
| | | MFG APPVL: | -- -- |
| | | QA APPVL: | D. VARID 6/19/95 |
| | | MKT APPVL: | -- -- |
| | | PRD. FAM: | CM&R COMPRESSION |
| | | PROJECT #: | SIZE |
| | | DOCUMENT TYPE: | Sales |
| | | REL. LEVEL: | Released |
| | | SCALE: | NTS |
| | | DRAWING NO: | SD.073935 |
| | | SHEET 5 OF 10 | BD |

REV: PE0200

| 6 11 CATALOG NUMBER | 5 WIRE / CONDUCTOR SIZE | | | STUD SIZE | NO. OF HOLES | STUD HOLE DIAMETER (K) | FIG. | OUTSIDE DIAMETER (OD) | BARREL LENGTH (B) | PAD WIDTH (C) | PAD LENGTH (D) | HOLE SPACING (E >> F) | OVERALL LENGTH (L) | HOLE OFFSET (N) | PAD THICKNESS (T) | HEIGHT (H) | COLOR CODE | DIE INDEX | WIRE STRIP LENGTH | 4 TEMP RATING |
|---------------------------|----------------------------|------------|-----------------------------------------------------|-----------|--------------|------------------------|------|-----------------------|-------------------|---------------|----------------|-----------------------|--------------------|-----------------|-------------------|------------|------------|-----------|-------------------|------------------|
| | ALUMINUM | COPPER | CCA | | | | | | | | | | | | | | | | | |
| YA44A1 | 1000 KCMIL | 1000 KCMIL | 750 KCMIL DLO (1184/22) 800 KCMIL DLO (1258/22) | 5/8 | 1 | .69 [18] | 1 | 1.84 [47] | 2.74 [70] | 2.50 [64] | 1.89 [48] | | 6.50 [165] | .88 [22] | .66 [17] | | BROWN | 302 | 3-1/8" | 90°C |
| YA44A3 | 1000 KCMIL | 1000 KCMIL | 750 KCMIL DLO (1184/22) 800 KCMIL DLO (1258/22) | 1/2 | 2 | .56 [14] | 2 | 1.84 [47] | 2.74 [70] | 1.65 [42] | 3.15 [80] | 1.75 [44] | 7.76 [197] | .63 [16] | .55 [14] | | BROWN | 302 | 3-1/8" | 90°C |
| YA44A6 | 1000 KCMIL | 1000 KCMIL | 750 KCMIL DLO (1184/22) 800 KCMIL DLO (1258/22) | 1/2 | 4 | .56 [14] | 3 | 1.84 [47] | 2.74 [70] | 3.03 [77] | 3.15 [80] | 1.75 [44] | 7.76 [197] | .63 [16] | .53 [13] | | BROWN | 302 | 3-1/8" | 90°C |
| YA45A5 | 1250 KCMIL | 1250 KCMIL | 900 KCMIL DLO (1406/22) 1000 KCMIL DLO (1554/22) | 1/2 | 2 | .56 [14] | 2 | 1.84 [47] | 2.74 [70] | 2.59 [66] | 3.12 [79] | 1.75 [44] | 7.73 [196] | .63 [16] | .51 [13] | | BROWN | 302 | 3-1/8" | 75°C |
| YA45A7 | 1250 KCMIL | 1250 KCMIL | 900 KCMIL DLO (1406/22) 1000 KCMIL DLO (1554/22) | 1/2 | 4 | .56 [14] | 3 | 1.84 [70] | 2.74 [70] | 3.03 [77] | 3.12 [12] | 1.75 [44] | 7.73 [196] | .63 [16] | .43 [11] | | BROWN | 302 | 3-1/8" | 75°C |
| YA46A3 | 1500 KCMIL | 1500 KCMIL | | 1/2 | 2 | .56 [14] | 2 | 2.26 [57] | 3.30 [84] | 3.08 [78] | 3.15 [80] | 1.75 [44] | 8.73 [222] | .63 [16] | .81 [21] | | BLUE | 478 | 3-3/4" | 75°C |
| YA46A5 | 1500 KCMIL | 1500 KCMIL | | 1/2 | 4 | .56 [14] | 3 | 2.26 [57] | 3.30 [84] | 3.08 [78] | 3.15 [80] | 1.75 [44] | 8.73 [222] | .63 [16] | .81 [21] | | BLUE | 478 | 3-3/4" | 75°C |
| YA48A3 | 2000 KCMIL | 2000 KCMIL | | 1/2 | 2 | .56 [14] | 2 | 2.60 [66] | 3.69 [94] | 3.57 [91] | 3.11 [79] | 1.75 [44] | 8.49 [216] | .63 [16] | .90 [23] | | RED | 479 | 4-1/8" | 75°C |
| YA48A8 | 2000 KCMIL | 2000 KCMIL | | 1/2 | 2 | .66 [17] | 2 | 2.60 [66] | 3.69 [94] | 2.60 [66] | 3.00 [76] | 1.75 [44] | 8.40 [216] | .55 [14] | .90 [23] | | RED | 479 | 4-1/8" | 75°C |
| YA48A5 | 2000 KCMIL | 2000 KCMIL | | 1/2 | 4 | .56 [14] | 3 | 2.60 [66] | 3.69 [94] | 3.57 [91] | 3.11 [79] | 1.75 [44] | 8.49 [216] | .63 [16] | .90 [23] | 4.59 [117] | RED | 479 | 4-1/8" | 75°C |

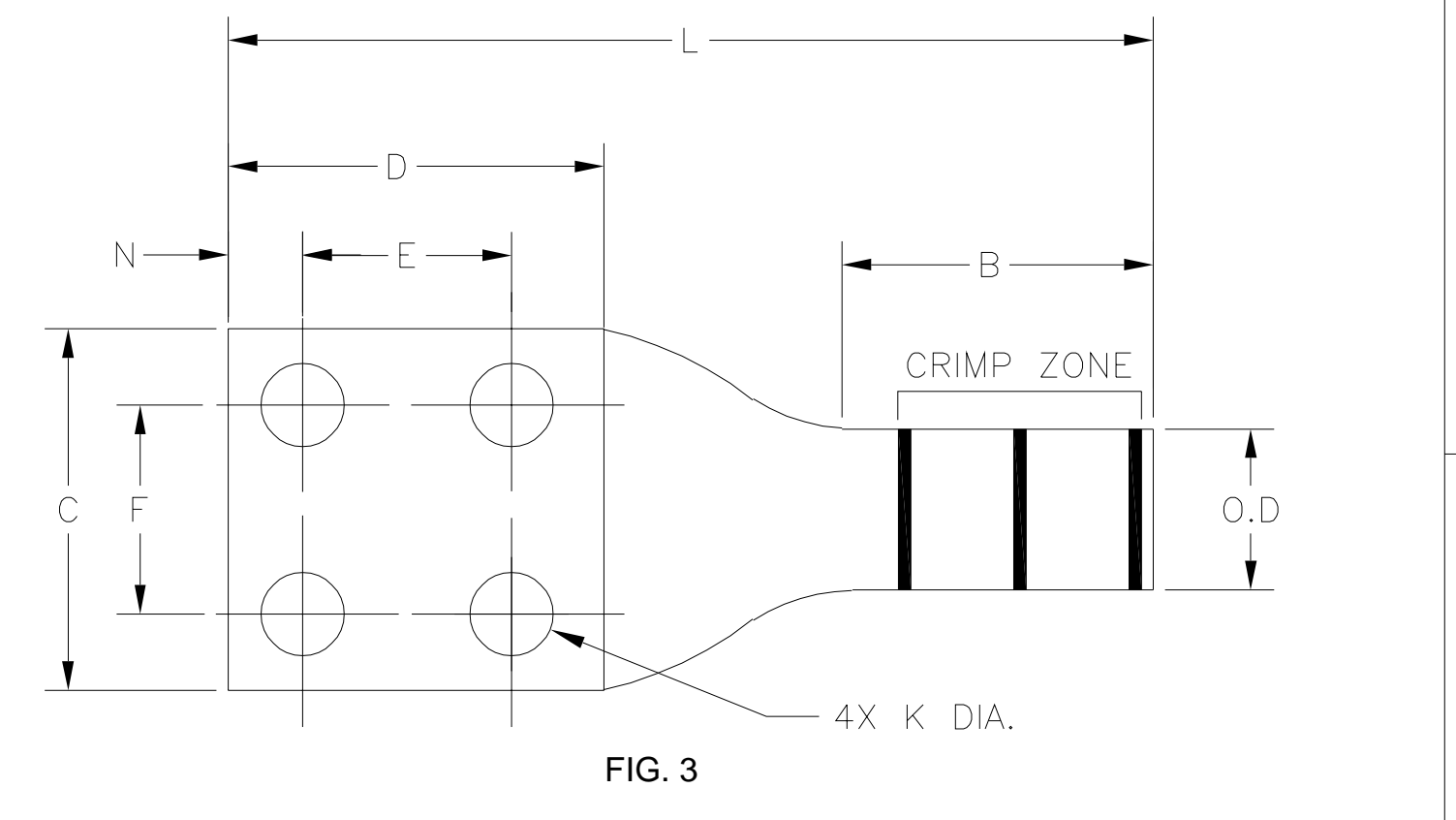
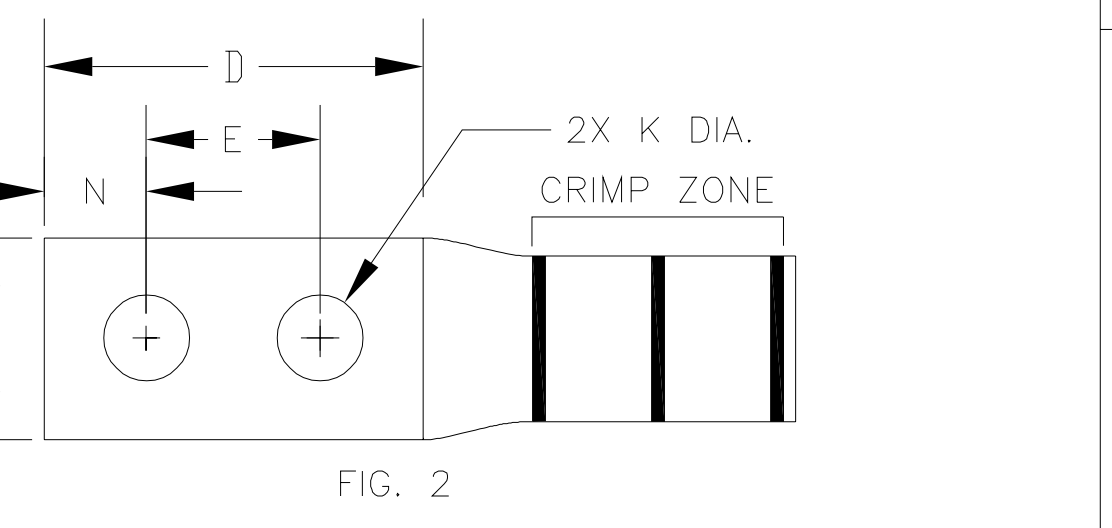
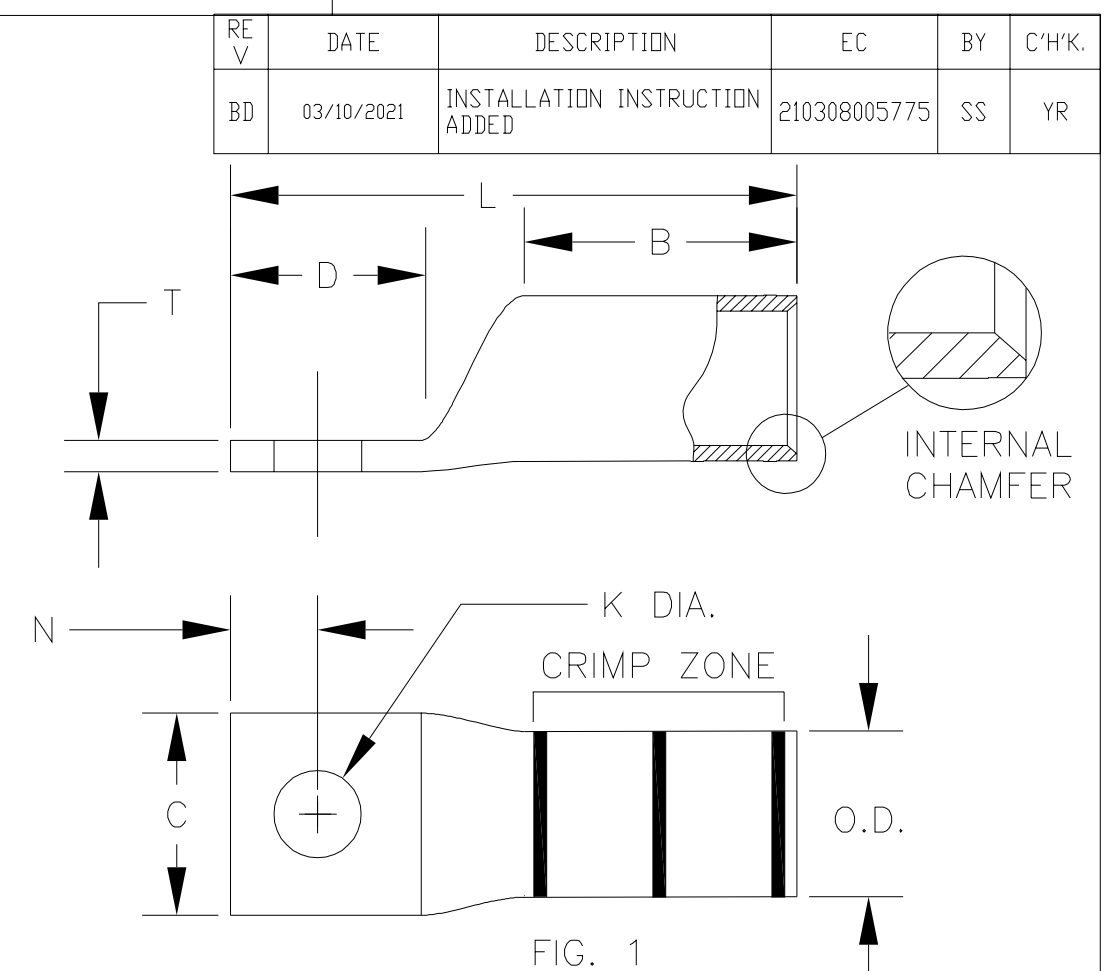

NOTES:

- CONNECTOR: UNINSULATED ALUMINUM COMPRESSION TERMINAL. MADE FROM SEAMLESS ALUMINUM TUBING.
- CONNECTION: COMPRESSION CONNECTIONS MADE ARE IRREVERSIBLE AND MAINTENANCE FREE.
- APPLICABLE STANDARDS: PRODUCTS ARE ONLY UL LISTED AND CSA CERTIFIED WHEN INSTALLED USING THE BURNDY ENGINEERED SYSTEM: TOOLS, DIES (IF APPLICABLE), AND CONNECTORS. THE USE OF OTHER INDUSTRY TOOLING AND OR DIES ON BURNDY CONNECTORS WILL VOID THE UL LISTING AND CSA CERTIFICATIONS.
 - UL LISTING TO UL486A-486B-WIRE CONNECTORS
 - CSA C22.2
- TEMPERATURE AND VOLTAGE RATING:
 - UL LISTED 90°C OR 75°C, UP TO 35kV *SEE CONNECTOR FINISHES FOR ADDITIONAL SERVICE TEMPERATURE RATINGS.
 - ALUMINUM CONNECTORS MARKED AL9CU ACCOMMODATE ALUMINUM (AL) AND COPPER (CU) CODE WIRE UP TO 90°C.
 - ALUMINUM CONNECTORS MARKED AL7CU ACCOMMODATE ALUMINUM (AL) AND COPPER (CU) CODE WIRE UP TO 75°C.
- WIRE ACCOMMODATE TYPES (SEE TABLE): DUAL RATED TO ACCOMMODATE ALUMINUM AND COPPER WIRE.
 - CODE ALUMINUM WIRE (CU): CLASS B (CONCENTRIC, COMPRESS, COMPACT) STRANDING.
 - CODE COPPER WIRE (AL): CLASS B (CONCENTRIC, COMPRESS, COMPACT) OR CLASS C STRANDING.
 - COPPER CLAD ALUMINUM (CCA) STRANDING: SEE TABLE FOR SELECT TERMINALS AND APPLICABLE CCA WIRE SIZES.
- CONNECTOR FINISHES AND SUFFIX: SEE SECTION C OF THE BURNDY MASTER CATALOG FOR PLATING SERVICE TEMPERATURE RATINGS.
 - ELECTRO-TIN PLATED: CONNECTORS HAVING NO SUFFIX ARE TIN PLATED UNLESS OTHERWISE SPECIFIES. CATALOG NUMBER EXAMPLE: YA34A3.
 - NICKEL PLATED: APPLY SUFFIX "NK" TO A CATALOG NUMBER IN THE TABLE, IF NOT SPECIFIED. CATALOG NUMBER EXAMPLE: YA34A3NK.
 - SILVER PLATED: APPLY SUFFIX "SV" TO A CATALOG NUMBER IN THE TABLE, IF NOT SPECIFIED. CATALOG NUMBER EXAMPLE: YA34A3SV.
 - TIN ZINC : APPLY SUFFIX "TZ" TO A CATALOG NUMBER IN THE TABLE, IF NOT SPECIFIED. CATALOG NUMBER EXAMPLE: YA34A3TZ.
 - BARE CONNECTORS: APPLYING SUFFIX "BR" TO A CATALOG NUMBER IN THE TABLE, IF NOT SPECIFIED. CATALOG NUMBER EXAMPLE: YA343BR.
- FEATURES:
 - BARREL TYPICAL ROLL MARKINGS (AS SPACE PERMITS): CRIMP ZONE IS INDICATED BY KNURL BANDS, BURNDY CORPORATE NAME OR LOGO, UL LOGO (IF APPLICABLE), CSA LOGO (IF APPLICABLE), WIRE SIZE, DIE COLOR CODE (IF SPACE PERMITS), DIE INDEX NUMBER.
 - BARREL DESIGN: BARREL END AT THE WIRE HAS AN INTERNAL CHAMFER, ALLOWING FOR A SMOOTH WIRE INSERTION.
 - TERMINALS ARE PRE-FILLED WITH PENETROX™ A13, WHICH IS AN OXIDE INHIBITOR.
 - EACH TERMINAL HAS A COLOR-CODED END CAP TO MATCH THE DIE COLOR CODE. THIS ALSO PREVENTS PARTICLES FROM ENTERING THE BARREL.
 - PAD/TONGUE/TANG/SPADE DESIGN: ONE-HOLE, TWO-HOLE, AND FOUR HOLE DESIGNS. CONTACT CUSTOMER SERVICE FOR ALTERNATE PAD CONFIGURATIONS.
 - FIELD BENDING STRAIGHT LUGS TO ACHIEVE AN ANGULAR CONNECTION WILL VOID ALL APPLICABLE STANDARDS LISTED IN NOTE 2.
 - CATALOG NUMBER SUFFIX DT OR DTS: INDICATES THAT THE TRANSITION IN THE TERMINAL BETWEEN THE PAD AND BARREL ARE SOLDER OR BRAZE SEALED TO BE OIL TIGHT INSIDE THE BARREL. THIS PREVENTS ANY LIQUIDS FROM EXITING OR ENTERING THE BARREL THROUGH THE PAD.
 - IF NOT LISTED IN THE TABLE, PLEASE CONTACT CUSTOMER SERVICE FOR 45°, 90°, AND OR OTHER ANGULAR LUGS FOR PRODUCT AVAILABILITY. CATALOG NUMBER SUFFIX 45 INDICATES THAT THE TERMINAL IS BENT AT A 45 DEGREE ANGLE. CATALOG NUMBER SUFFIX 90 INDICATES THAT THE TERMINAL IS BENT AT A 90 DEGREE ANGLE.
- INSTALLATION TOOLING AND DIES ARE CONSTANTLY BEING UPDATED. PLEASE SEE BURNDY MASTER CATALOG FOR THIS PRODUCT FAMILY, WHICH CAN BE FOUND ON THE BURNDY WEBSITE.
- SPECIAL REQUIREMENTS:
 - YA39A- CONNECTORS: 900 KCMIL CLASS B COMPACT WIRE REQUIRES THE USE OF THE 644 SERIES OR 444 SERIES DIE-LESS INSTALLATION TOOLS AND 2 CRIMPS.
 - YA42A- CONNECTORS: 600 KCMIL CU REQUIRES THE USE OF THE 644 SERIES OR 444 SERIES DIE-LESS INSTALLATION TOOLS.
 - YA44A- CONNECTORS ACCOMMODATE 1100 KCMIL WIRE CLASS A AND CLASS B COMPACT, BUT IS NOT UL LISTED OR CSA CERTIFIED.
- DIMENSIONS IN BRACKETS [] ARE IN MILLIMETERS ROUNDED OFF TO THE NEAREST MILLIMETER, UNLESS OTHERWISE SPECIFIED AND ARE FOR REFERENCE ONLY.
- CATALOG NUMBER SCHEME: EX: YA34A3.
 - Y = COMPRESSION, A = TERMINAL, 34 = WIRE SIZE (500 KCMIL), A = ALUMINUM CONNECTOR, 3 = HOLE SIZE AND PATTERN.

TYPICAL MARKINGS:

- BURNDY COMPANY IDENTIFIER
- UL LOGO, IF APPLICABLE
- CSA LOGO, IF APPLICABLE
- BURNDY CATALOG NUMBER
- WIRE ACCOMMODATES
- COLOR CODE IDENTIFIER
- DIE INDEX NUMBER
- CRIMP ZONE BANDS (KNURL MARKS)

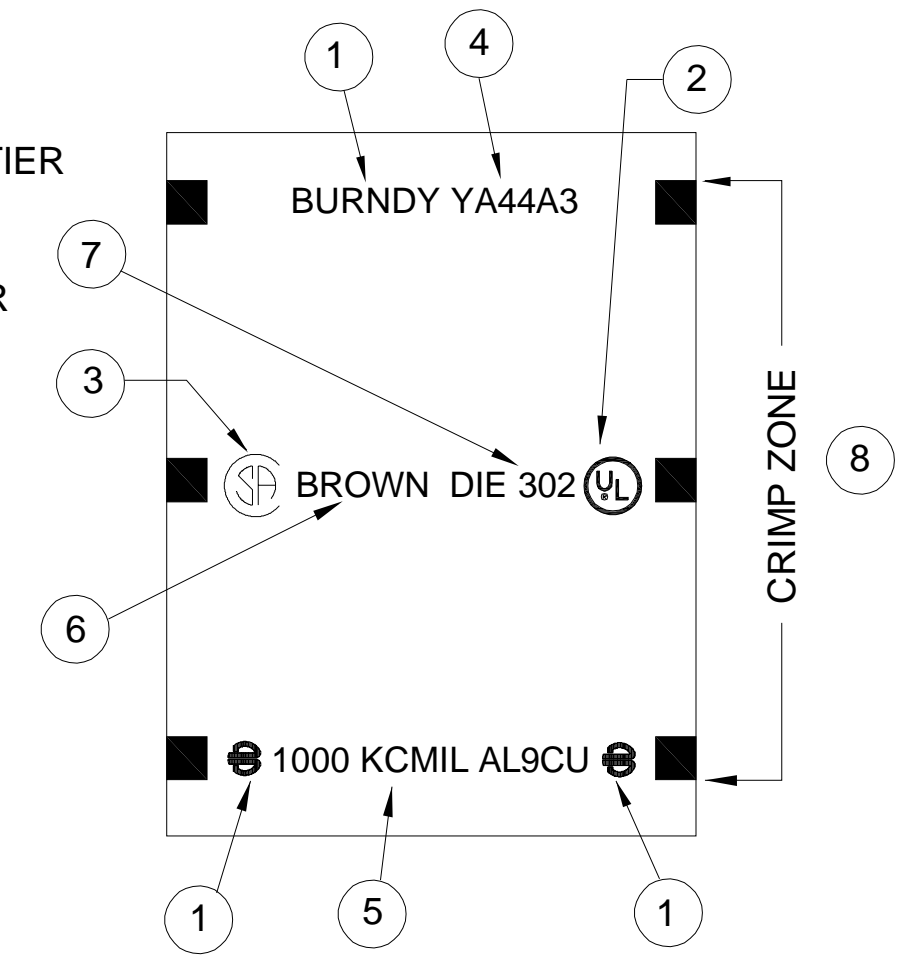

| TO ORDER BURNDY® PRODUCTS CALL | | HYLUG™ | |
|-----------------------------------------------------------------------------|--|----------------------------|------------------------------|
| UNITED STATES 1-800-346-4175 (LONDONDERRY, NH) | | ITEM NO: N/A | CAT. NO: YABCA - (SEE TABLE) |
| CANADA: 1-800-361-6975 (QUEBEC) 1-800-387-6487 (ALL OTHER PROVINCES) | | DRAWN BY: E.S.K. 7/19/72 | CHECKER: S.F.P. 8/01/72 |
| FOR PRODUCT INFO: http://www.burndy.com | | DSN APPVL: R.B. 8/02/72 | MFG APPVL: -- -- |
| | | QA APPVL: D. VARID 6/19/95 | MKT APPVL: -- -- |
| | | PRD. FAM: CM&R COMPRESSION | DRAWING NO: SD.073935 |
| | | PROJECT #: -- | SIZE: D |
| | | DOCUMENT TYPE: Sales | SHEET 6 OF 10 |
| | | REL. LEVEL: Released | SCALE: NTS |
| | | | REV: BD |

| REV | DATE | DESCRIPTION | EC | BY | CHK. |
|-----|------------|--------------------------------|--------------|----|------|
| BD | 03/10/2021 | INSTALLATION INSTRUCTION ADDED | 210308005775 | SS | YR |

| CATALOG NUMBER DESIGNATION | WIRE SIZE ACCOMMODATES | Wire Strip Length | COLOR CODE INDEX# | Mechanical & Ratchet Dies Required (# Crimps) | | Mechanical & Ratchet Dedicated Die Tools # Crimps | |
|----------------------------|------------------------|-------------------|-------------------|-----------------------------------------------|-----------------------|---------------------------------------------------|----------|
| | Class B, C (AL/CU) | | | MD6 and MD7 Series | OUR840 | MY28 and MY29 Series | MRC840AL |
| YA8CA- | #8 AWG | 5/8 | BLUE 374 | X8CART (2) W374 (1) | X8CART (2) | 1 CRIMP | 1 CRIMP |
| YA6CA- | #6 AWG | 3/4 | Gray 346 | X6CART (2) | X6CART (2) | 1 CRIMP | 1 CRIMP |
| | | | No Color 161 | W161 (1) | X161 (2) | -- | -- |
| YA4CA- | #4 AWG | 1 | Green 375 | X4CART (3) | X4CART (3) | 1 CRIMP | 2 CRIMP |
| | | | No Color 162 | W162 (3) | -- | -- | -- |
| YA2CA- | #2 AWG | 1-1/4 | Pink 348 | X2CART (4) | X2CART (4) | 2 CRIMP | 2 CRIMP |
| | | | No Color 163 | W163 (3) | -- | -- | -- |
| | | | No Color 239 | W239 (2) | X239 (4) | -- | -- |
| YA1CA- | #1 AWG | 1-1/16 | Gold 471 | X1CART (3) | X1CART (3) | 2 CRIMP | 2 CRIMP |
| | | | No Color 163 | W163 (3) | -- | -- | -- |
| YA25A- | 1/0 AWG | 1-3/16 | Tan 296 | X25ART (4) | X25ART (4) | 2 CRIMP | 2 CRIMP |
| | | | No Color 241 | W241 (2) | X241 (4) | -- | -- |
| YA26A- | 2/0 AWG | 1-3/8 | Olive 297 | X26ART (4) WBG (2) | X26ART (4) XBG (4) | 2 CRIMP | 3 CRIMP |
| | | | No Color 245 | W245 (3) | X245 (4) | -- | -- |
| YA27A- | 3/0 AWG | 1-1/2 | Ruby 467 | X27ART (4) | X27ART (4) | 2 CRIMP | 3 CRIMP |
| | | | No color 166 | W166 (4) | -- | -- | -- |
| YA28A- | 4/0 AWG | 1-5/8 | White 298 | X28ART (6) | X28ART (6) | 2 CRIMP | 3 CRIMP |
| | | | No color 660 | W660 (3) | X660 (8) | -- | -- |
| YA29A- | 250 kcmi | 1-5/8 | Red 324 | -- | -- | -- | -- |
| YA30A- | 300 kcmil | 1-3/4 | BLUE 470 | -- | -- | -- | -- |
| YA31A- | 350 kcmil | 2-1/8 | BROWN 299 | W31ART (4) | -- | -- | -- |
| YA32A- | 400 kcmil | 2-1/2 | Green 472 | -- | -- | -- | -- |
| YA34A- | 500 kcmil | 2-5/8 | PINK 300 | -- | -- | -- | -- |
| YA36A- | 600 kcmil | 2-7/8 | Black 473 | -- | -- | -- | -- |
| YA39A- | 700 - 750 kcmil | 2-7/8 | Yellow 936 | -- | -- | -- | -- |
| YA40A- | 800 kcmil | 3 | Gray 474 | -- | -- | -- | -- |
| YA42A- | 900 AL kcmil | 2-7/8 | Gray 303 | -- | -- | -- | -- |
| YA44A- | 1000 kcmil | 3-1/8 | Gray 474 | -- | -- | -- | -- |
| YA45A- | 1250 kcmil | 3-1/8 | BROWN 302 | -- | -- | -- | -- |
| YA46A- | 1500 kcmil | 3-3/4 | Blue 478 | -- | -- | -- | -- |
| YA47A- | 1750 kcmil | 4-3/8 | White 587 | -- | -- | -- | -- |
| YA48A- | 2000 kcmil | 4-1/8 | Red 479 | -- | -- | -- | -- |

| | | | |
|-----------------------------------------------------------------------------|--|----------------|---------------------|
| TO ORDER BURNDY® PRODUCTS CALL | | HYLUG™ | |
| UNITED STATES 1-800-346-4175 (LONDONDERRY, NH) | | ITEM NO: | N/A |
| CANADA: 1-800-361-6975 (QUEBEC) 1-800-387-6487 (ALL OTHER PROVINCES) | | CAT. NO: | YABCA - (SEE TABLE) |
| FOR PRODUCT INFO: http://www.burndy.com | | DRAWN BY: | E.S.K. 7/19/72 |
| | | CHECKER: | S.F.P. 8/01/72 |
| | | DSN APPVL: | R.B. 8/02/72 |
| | | MFG APPVL: | -- |
| | | QA APPVL: | D. VARID 6/19/95 |
| | | MKT APPVL: | -- |
| | | PRD FAM: | CM&R COMPRESSION |
| | | PROJECT #: | --- |
| | | DOCUMENT TYPE: | Sales |
| | | REL LEVEL: | Released |
| | | DRAWING NO | SD.073935 |
| | | SCALE | 1 |
| | | NTS | BD |
| | | SHEET | 7 OF 10 |

REV: PE0200

| REV | DATE | DESCRIPTION | EC | BY | CHK. |
|-----|------------|--------------------------------|--------------|----|------|
| BD | 03/10/2021 | INSTALLATION INSTRUCTION ADDED | 210308005775 | SS | YR |

| CATALOG NUMBER DESIGNATION | WIRE SIZE ACCOMMODATES | Wire Strip Length | COLOR CODE INDEX# | Hydraulic Tools - Dies Required (# Crimps) | | | | |
|----------------------------|------------------------|-------------------|-------------------|--------------------------------------------|----------------|----------------------------------|----------------------------------|-------------|
| | Class B, C (AL/CU) | | | MD6, 600, 500 Series | 750, 35 Series | 45 Series Use PT6515 with U Dies | 46 Series Use PUADP1 with U Dies | 60 Series |
| YA8CA- | #8 AWG | 5/8 | BLUE 374 | X8CART (2) W374 (1) | U8CABT (1) | U8CABT (1) | U8CABT (1) | -- |
| YA6CA- | #6 AWG | 3/4 | Gray 346 | X6CART (2) | U6CABT (1) | U6CABT (1) | U6CABT (1) | -- |
| | | | No Color 161 | W161 (1) X161 (2) | -- | -- | -- | -- |
| YA4CA- | #4 AWG | 1 | Green 375 | X4CART (3) | U4CABT (1) | U4CABT (1) | U4CABT (1) | -- |
| | | | No Color 162 | W162 (3) | -- | -- | -- | -- |
| YA2CA- | #2 AWG | 1-1/4 | Pink 348 | X2CART (4) | U2CABT (1) | U2CABT (1) | U2CABT (1) | -- |
| | | | No Color 163 | W163 (3) | -- | -- | -- | -- |
| | | | No Color 239 | W239 (2) | -- | -- | -- | -- |
| YA1CA- | #1 AWG | 1-1/16 | Gold 471 | X1CART (3) | U1CART (1) | U1CART (1) | U1CART (1) | -- |
| | | | No Color 163 | W163 (3) | -- | -- | -- | -- |
| YA25A- | 1/0 AWG | 1-3/16 | Tan 296 | X25ART (4) | U25ART (1) | U25ART (1) | U25ART (1) | -- |
| | | | No Color 241 | W241 (2) | -- | -- | -- | -- |
| YA26A- | 2/0 AWG | 1-3/8 | Olive 297 | X26ART (4) WBG (2) | U26ART (2) | U26ART (2) | U26ART (2) | -- |
| | | | No Color 245 | W245 (3) | -- | -- | -- | -- |
| YA27A- | 3/0 AWG | 1-1/2 | Ruby 467 | X27ART (4) | U27ART (2) | U27ART (2) | U27ART (2) | -- |
| | | | No color 166 | W166 (4) | -- | -- | -- | -- |
| YA28A- | 4/0 AWG | 1-5/8 | White 298 | X28ART (6) | U28ART (2) | U28ART (2) | U28ART (2) | L28ART (1) |
| | | | No color 660 | W660 (3) | -- | -- | -- | -- |
| YA29A- | 250 kcmil | 1-5/8 | Red 324 | -- | U29ART (2) | U29ART (2) | U29ART (2) | L29ART (1) |
| YA30A- | 300 kcmil | 1-3/4 | BLUE 470 | -- | U30ART (2) | U30ART (2) | U30ART (2) | L30ART (1) |
| YA31A- | 350 kcmil | 2-1/8 | BROWN 299 | W31ART (4) | U31ART (2) | U31ART (2) | U31ART (2) | L31ART (1) |
| YA32A- | 400 kcmil | 2-1/2 | Green 472 | -- | U32ART (4) | U32ART (4) | U32ART (4) | L32ART (2) |
| YA34A- | 500 kcmil | 2-5/8 | PINK 300 | -- | U34ART (4) | U34ART (4) | U34ART (4) | L34ART (2) |
| YA36A- | 600 kcmil | 2-7/8 | Black 473 | -- | U36ART (4) | U36ART (4) | U36ART (4) | L36ART (2) |
| YA39A- | 700 - 750 kcmil | 2-7/8 | Yellow 936 | -- | U39ART2 (4) | U39ART2 (4) | U39ART2 (4) | L39ART2 (2) |
| YA40A- | 800 kcmil | 3 | Gray 474 | -- | -- | S40ART (4) | P40ART (4) | L40ART (2) |
| YA42A- | 900 AL kcmil | 2-7/8 | Gray 303 | -- | -- | U42ART (4) | U42ART (4) | -- |
| YA44A- | 1000 kcmil | 3-1/8 | Gray 474 | -- | -- | S44ART (4) | P44ART (4) | L44ART (2) |
| YA45A- | 1250 kcmil | 3-1/8 | BROWN 302 | -- | -- | S44ART (4) | P44ART (4) | L44ART (2) |
| YA46A- | 1500 kcmil | 3-3/4 | Blue 478 | -- | -- | -- | -- | L46ART (2) |
| YA47A- | 1750 kcmil | 4-3/8 | White 587 | -- | -- | -- | -- | L47ART (2) |
| YA48A- | 2000 kcmil | 4-1/8 | Red 479 | -- | -- | -- | -- | L48ART (2) |

| | | | |
|--------------------------------------------------------------------------------------------------------------------------------------------------------------------------------------------------------------------------------------------------|------------------|---------------------|-----------|
| TO ORDER BURNDY® PRODUCTS CALL UNITED STATES 1-800-346-4175 (LONDONDERRY, NH) CANADA: 1-800-361-6975 (QUEBEC) 1-800-387-6487 (ALL OTHER PROVINCES) FOR PRODUCT INFO: http://www.burndy.com | | HYLUG™ | |
| | | ITEM NO: | N/A |
| CAT. NO: | | YABCA - (SEE TABLE) | |
| DRAWN BY: | E.S.K. | 7/19/72 | |
| CHECKER: | S.F.P. | 8/01/72 | |
| DSN APPVL: | R.B. | 8/02/72 | |
| MFG APPVL: | -- | -- | |
| QA APPVL: | D. VARID | 6/19/95 | |
| MKT APPVL: | -- | -- | |
| PROD FAM: | CM&R COMPRESSION | DRAWING NO | SCALE NTS |
| PROJECT #: | -- | SIZE | REV |
| DOCUMENT TYPE: | Sales | SD.073935 | BD |
| REL LEVEL: | Released | SHEET 8 OF 10 | |

REV: PE0200

| CATALOG NUMBER DESIGNATION | WIRE SIZE ACCOMMODATES | | Wire Strip Length | COLOR CODE INDEX# | Hydraulic Tools - Dieless # CRIMPSs | | | |
|----------------------------|------------------------|----------------------------------------------------------------|-------------------|-------------------|-------------------------------------|------------|-------------|---------------------|
| | Class B, C (AL/CU) | Copper Clad Aluminum (CCA) Only for use with 644 / 444S Series | | | 81K, 4PC Series | 644 Series | 444S Series | Y644MBH Remote Head |
| YA8CA- | #8 AWG | -- | 5/8 | BLUE 374 | 1 CRIMP | -- | -- | -- |
| YA6CA- | #6 AWG | -- | 3/4 | Gray 346 | 1 CRIMP | 1 CRIMP | -- | 1 CRIMP |
| | | | | No Color 161 | -- | -- | -- | -- |
| YA4CA- | #4 AWG | -- | 1 | Green 375 | 1 CRIMP | 1 CRIMP | 1 CRIMP | 1 CRIMP |
| | | | | No Color 162 | -- | -- | -- | -- |
| YA2CA- | #2 AWG | -- | 1-1/4 | Pink 348 | 2 CRIMPS | 1 CRIMP | 1 CRIMP | 1 CRIMP |
| | | | | No Color 163 | -- | -- | -- | -- |
| | | | | No Color 239 | -- | -- | -- | -- |
| YA1CA- | #1 AWG | -- | 1-1/16 | Gold 471 | 2 CRIMPS | 1 CRIMP | 1 CRIMP | 1 CRIMP |
| | | | | No Color 163 | -- | -- | -- | -- |
| YA25A- | 1/0 AWG | -- | 1-3/16 | Tan 296 | 2 CRIMPS | 1 CRIMP | 1 CRIMP | 1 CRIMP |
| | | | | No Color 241 | -- | -- | -- | -- |
| YA26A- | 2/0 AWG | -- | 1-3/8 | Olive 297 | 2 CRIMPS | 1 CRIMP | 1 CRIMP | 1 CRIMP |
| | | | | No Color 245 | -- | -- | -- | -- |
| YA27A- | 3/0 AWG | -- | 1-1/2 | Ruby 467 | 2 CRIMPS | 1 CRIMP | 1 CRIMP | 1 CRIMP |
| | | | | No color 166 | -- | -- | -- | -- |
| YA28A- | 4/0 AWG | -- | 1-5/8 | White 298 | 2 CRIMPS | 1 CRIMP | 1 CRIMP | 1 CRIMP |
| | | | | No color 660 | -- | -- | -- | -- |
| YA29A- | 250 kcmil | -- | 1-5/8 | Red 324 | 2 CRIMPS | 1 CRIMP | 1 CRIMP | 1 CRIMP |
| YA30A- | 300 kcmil | 4/0 AWG CCA DLO (329/22) | 1-3/4 | BLUE 470 | 2 CRIMPS | 1 CRIMP | 1 CRIMP | 1 CRIMP |
| YA31A- | 350 kcmil | 250 kcmil CCA DLO (399/22) | 2-1/8 | BROWN 299 | 3 CRIMPS | 1 CRIMP | 1 CRIMP | 1 CRIMP |
| YA32A- | 400 kcmil | -- | 2-1/2 | Green 472 | 4 CRIMPS | 1 CRIMP | 1 CRIMP | 1 CRIMP |
| YA34A- | 500 kcmil | 350 kcmil CCA DLO (779/22) | 2-5/8 | PINK 300 | 4 CRIMPS | 1 CRIMP | 1 CRIMP | 1 CRIMP |
| YA36A- | 600 kcmil | 500 kcmil CCA DLO (779/22) | 2-7/8 | Black 473 | 4 CRIMPS | 1 CRIMP | 1 CRIMP | 1 CRIMP |
| YA39A- | 700 - 750 kcmil | 600 kcmil CCA DLO (925/22) | 2-7/8 | Yellow 936 | 4 CRIMPS | 1 CRIMP | 1 CRIMP | 1 CRIMP |
| YA40A- | 800 kcmil | -- | 3 | Gray 474 | -- | 1 CRIMP | 1 CRIMP | 1 CRIMP |
| YA42A- | 900 AL kcmil | -- | 2-7/8 | Gray 303 | -- | 2 CRIMPS | 2 CRIMPS | 2 CRIMPS |
| YA44A- | 1000 kcmil | 750 kcmil CCA DLO (1184/22) 800 kcmil CCA DLO (1258/22) | 3-1/8 | Gray 474 | -- | -- | 1 CRIMP | 1 CRIMP |
| YA45A- | 1250 kcmil | 900 kcmil CCA DLO (1406/22) 1000 kcmil CCA DLO (1554/22) | 3-1/8 | BROWN 302 | -- | -- | -- | -- |
| YA46A- | 1500 kcmil | -- | 3-3/4 | Blue 478 | -- | -- | -- | -- |
| YA47A- | 1750 kcmil | -- | 4-3/8 | White 587 | -- | -- | -- | -- |
| YA48A- | 2000 kcmil | -- | 4-1/8 | Red 479 | -- | -- | -- | -- |

| REV | DATE | DESCRIPTION | EC | BY | CHK. |
|-----|------------|--------------------------------|--------------|----|------|
| BD | 03/10/2021 | INSTALLATION INSTRUCTION ADDED | 210308005775 | SS | YR |

| | | | |
|-----------------------------------------------------------------------------|--|----------------|---------------------|
| TO ORDER BURNDY® PRODUCTS CALL | | HYLUG™ | |
| UNITED STATES 1-800-346-4175 (LONDONDERRY, NH) | | ITEM NO: | N/A |
| CANADA: 1-800-361-6975 (QUEBEC) 1-800-387-6487 (ALL OTHER PROVINCES) | | CAT. NO: | YABCA - (SEE TABLE) |
| FOR PRODUCT INFO: http://www.burndy.com | | DRAWN BY: | E.S.K. 7/19/72 |
| | | CHECKER: | S.F.P. 8/01/72 |
| | | DSN APPVL: | R.B. 8/02/72 |
| | | MFG APPVL: | -- |
| | | QA APPVL: | D. VARIO 6/19/95 |
| | | MKT APPVL: | -- |
| | | PRD FAM: | CM&R COMPRESSION |
| | | PROJECT #: | -- |
| | | DOCUMENT TYPE: | Sales |
| | | REL LEVEL: | Released |
| | | DRAWING NO: | SD.073935 |
| | | SCALE: | 1 |
| | | NTS: | BD |
| | | SHEET: | 9 OF 10 |

REV: PE0200

Installation Instructions

Installation instructions help the installer understand proper wire preparation, proper insertion requirements, crimp zone location, individual crimp location, crimp order and crimp direction, to ensure safe and reliable wire connections. In order to obtain a UL Listing BURNDY certifies its products using the BURNDY Engineered System and select other crimp tool manufacturers in accordance with one or more UL categories.

Aluminum Installation Steps:

1. Select the appropriate connector based on:
Wire Material
Wire Construction
Wire Size
2. Strip the insulation to the appropriate wire strip length, based on the table's Wire Strip Length recommendation for the selected connector. Due to tolerances in the connector, wire strip length, and insulation stripping tools, this range may be 0" - 1/4". The exposed wire, also known as a "shiner", has no performance impact on the connection and there is no wire exposure requirement by BURNDY.
3. Wire brush the bare conductor to remove any oxides. DO NOT wire brush tin-plated connectors.
4. Apply PENETROX™ A13 oxide inhibitor to the bare conductor.
5. Insert the conductor into the barrel for the full length. The connector barrel is filled with PENETROX™ A13, so be aware of the following:
Oxide inhibitor may discharge from the barrel when wire is fully inserted.
Oxide inhibitor may cause resistance that could feel like the wire is fully inserted. Ensure you insert the wire with enough force to penetrate the oxide inhibitor barrier until you reach the full wire insertion distance.
6. Apply the proper number of crimps based on the installation tooling requirements. Use the illustrations as a guide on crimp placement and direction for the proper number of crimps.
7. Remove excess PENETROX™ A13 that may discharge during installation.

* "For simplicity, the images show a 1-hole connector, however, connectors are available 1-hole, 2-hole or more hole patterns."

| CATALOG NUMBER DESIGNATION | | | | | |
|----------------------------|--------|--------|--------|--------|--------|
| YA8CA- | YA6CA- | YA4CA- | YA2CA- | YA1CA- | YA25A- |

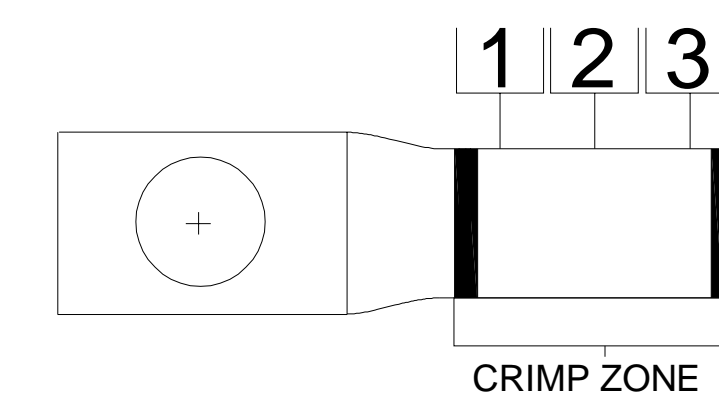
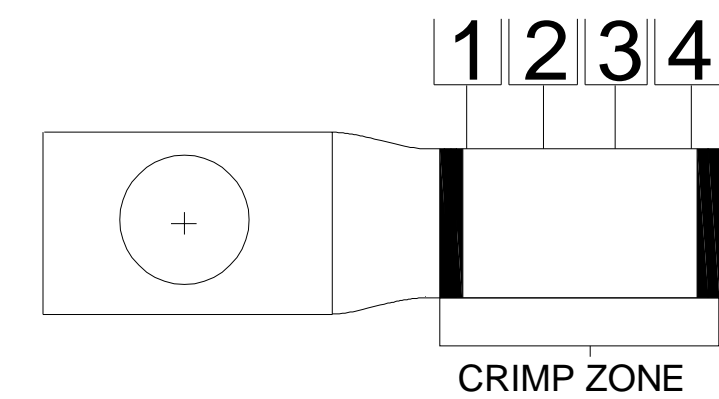
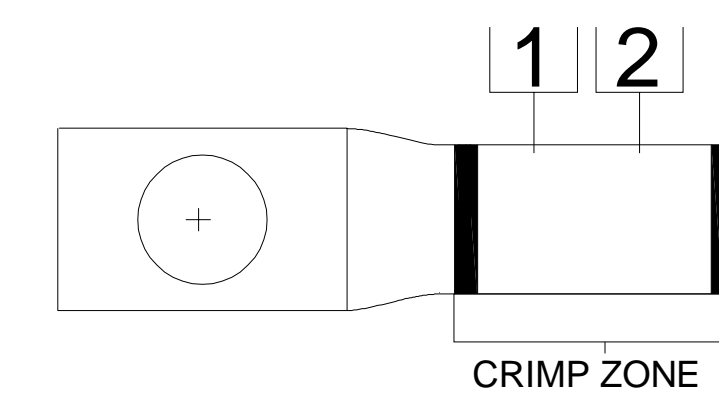
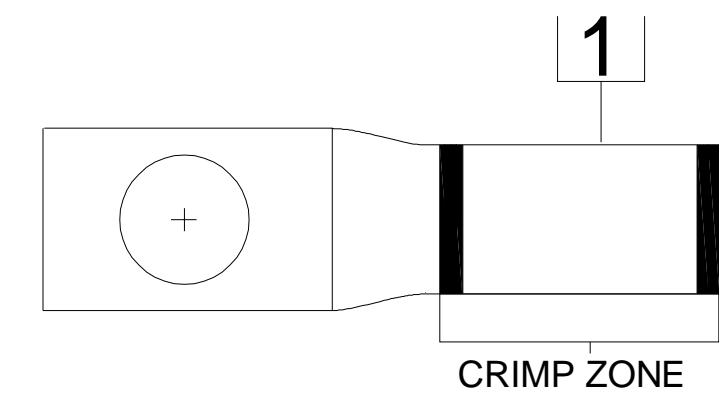

| CATALOG NUMBER DESIGNATION | | | | | |
|----------------------------|--------|--------|--------|--------|--------|
| YA26A- | YA27A- | YA28A- | YA29A- | YA30A- | YA31A- |
| YA39AM- | YA40A- | YA44A- | YA45A- | YA46A- | YA48A- |

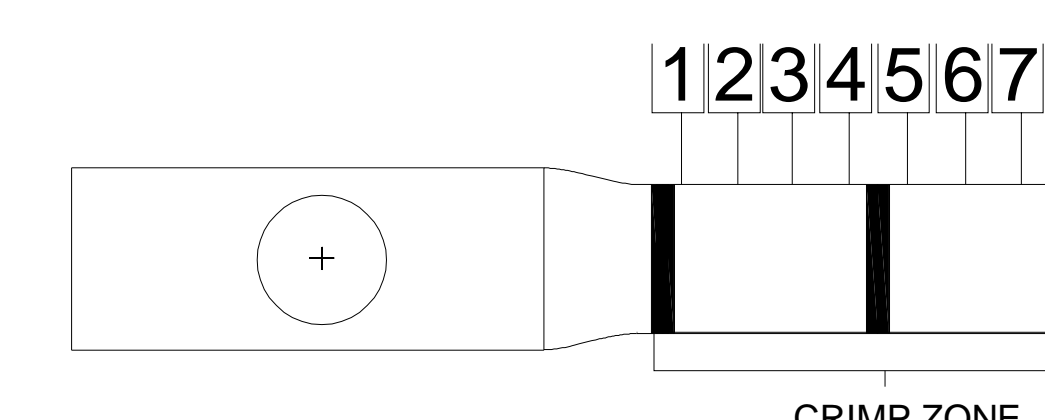
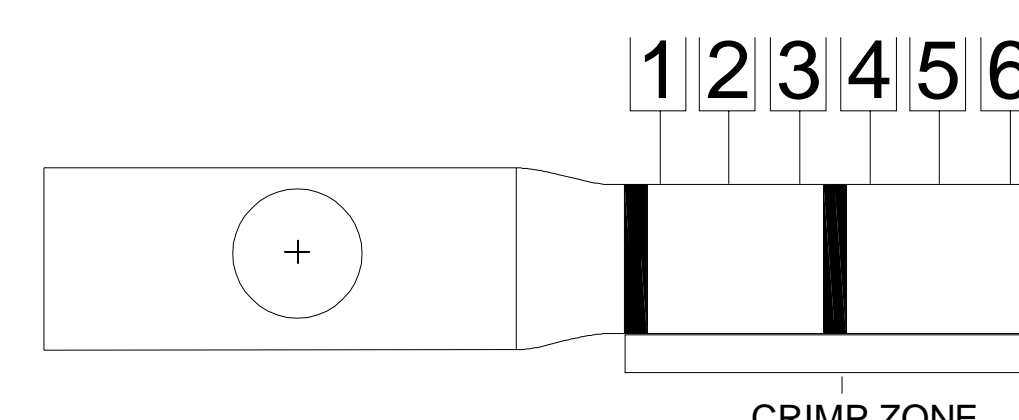
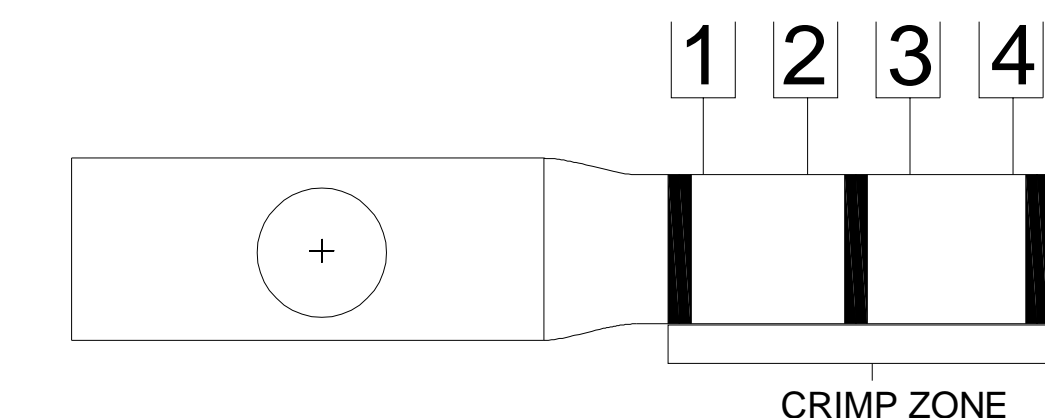
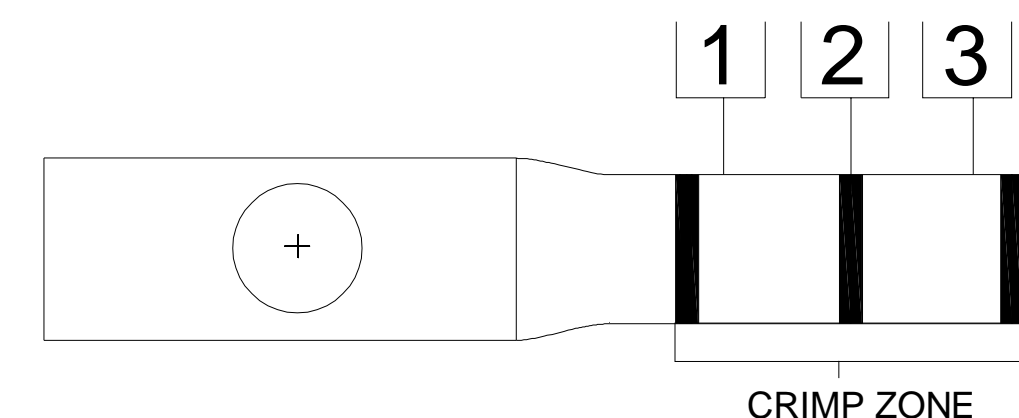
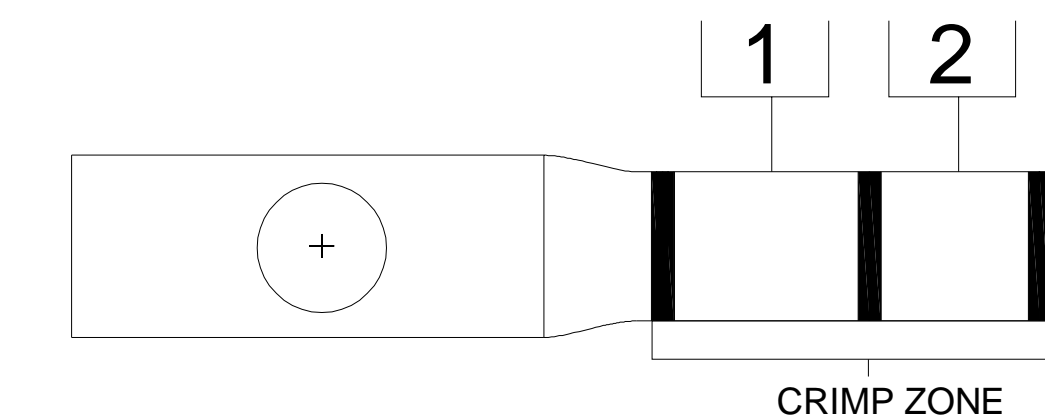
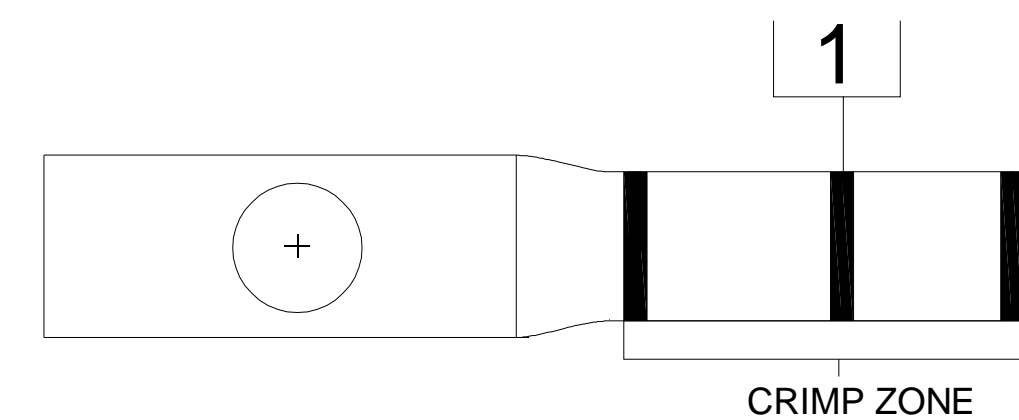

| CATALOG NUMBER DESIGNATION | | | | |
|----------------------------|--------|--------|--------|--------|
| YA32A- | YA34A- | YA36A- | YA39A- | YA42A- |

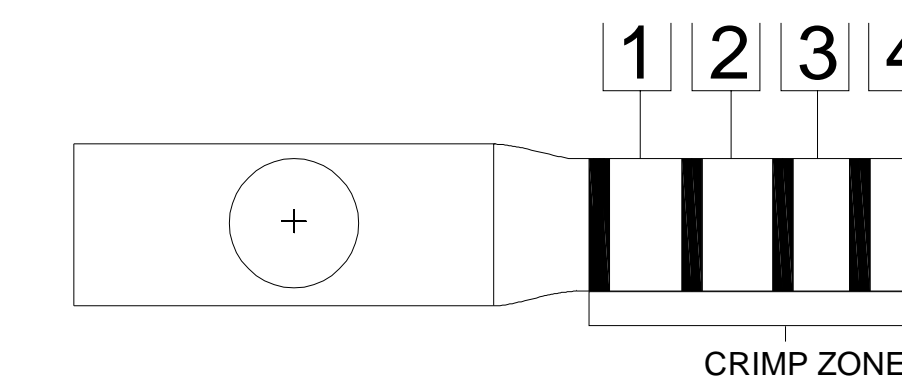
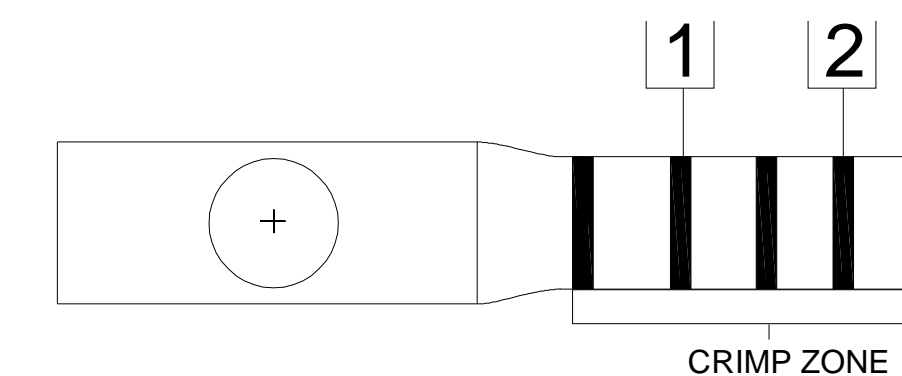
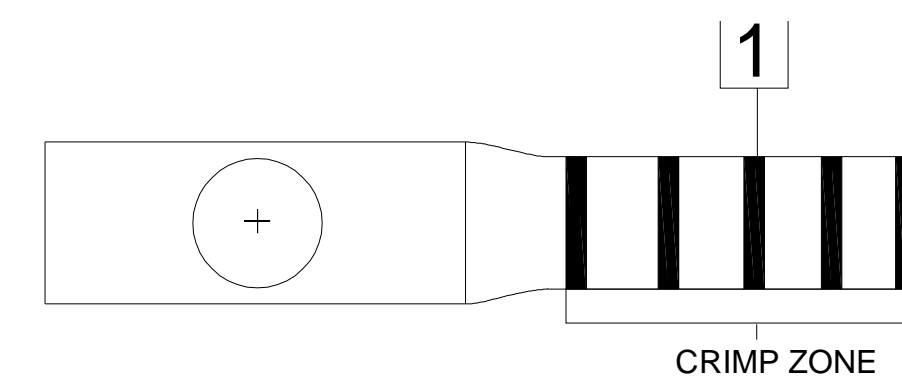

| | | | |
|-------------------------------------------------------------------------------------------------------------------------------------------------------------------------------------------------------------------------------------------------|--|-----------------------|------------|
| TO ORDER BURNDY® PRODUCTS CALL UNITED STATES 1-800-346-4175 (LONDONDERRY, NH) CANADA 1-800-361-6975 (QUEBEC) 1-800-387-6487 (ALL OTHER PROVINCES) FOR PRODUCT INFO: http://www.burndy.com | | HYLUG™ | |
| | | ITEM NO: N/A | SCALE: NTS |
| CAT. NO: YA8CA - (SEE TABLE) | | DRAWING NO: SD.073935 | |
| DRAWN BY: E.S.K. 7/19/72 | | REV: BD | |
| CHECKER: S.F.P. 8/01/72 | | SHEET 10 OF 10 | |
| DSN APPVL: R.B. 8/02/72 | | TYPE: Sales | |
| MFG APPVL: -- | | REL LEVEL: Released | |
| QA APPVL: D. VARID 6/19/95 | | MKT APPVL: -- | |
| PRD FAM: CM&R COMPRESSION | | PROJECT #: -- | |
| DOCUMENT TYPE: Sales | | D | |

REV: PE0200